

# WEST BAY SANITARY DISTRICT

SAN MATEO COUNTY CALIFORNIA

## BAYFRONT PARK

### SANITARY SEWER IMPROVEMENT PROJECT

#### GENERAL NOTES:

- THE FOLLOWING NOTES ARE ESTABLISHED MERELY TO GUIDE THE CONTRACTOR AS TO THE GENERAL ITEMS OF WORK INVOLVED AND ARE NOT INTENDED TO COVER COMPLETE SCOPE OF WORK. THE CONTRACTOR SHALL COMPLETE ALL WORK AS PER CONSTRUCTION PLANS AND SPECIFICATIONS.
- CONTRACTOR AGREES THAT THEY SHALL ASSUME SOLE AND COMPLETE RESPONSIBILITY FOR JOB SITE CONDITIONS DURING THE COURSE OF CONSTRUCTION OF THIS PROJECT, INCLUDING SAFETY OF ALL PERSONS AND PROPERTY; THAT THIS REQUIREMENT SHALL APPLY CONTINUOUSLY AND NOT BE LIMITED TO NORMAL WORKING HOURS; AND THAT THE CONTRACTOR SHALL DEFEND, INDEMNIFY AND HOLD THE OWNER AND THE ENGINEER HARMLESS FROM ANY AND ALL LIABILITY, REAL OR ALLEGED, IN CONNECTION WITH THE PERFORMANCE OF WORK ON THIS PROJECT, EXCEPT FOR LIABILITY ARISING FROM THE SOLE NEGLIGENCE OF THE OWNER OR THE ENGINEER.
- ALL SANITARY SEWERS SHALL BE CONSTRUCTED IN ACCORDANCE WITH THESE PLANS, THE SPECIAL TECHNICAL PROVISIONS AND THE STANDARD SPECIFICATIONS OF THE WEST BAY SANITARY DISTRICT. ALL WORK NOT SPECIFICALLY COVERED IN THE STANDARD SPECIFICATIONS OF WEST BAY SANITARY DISTRICT AND THE SPECIAL TECHNICAL PROVISIONS FOR THESE IMPROVEMENTS SHALL BE DONE IN ACCORDANCE WITH THE STATE OF CALIFORNIA, DEPARTMENT OF TRANSPORTATION SPECIFICATIONS, LATEST EDITION.
- THE WORK SHOWN ON THESE PLANS IS WITHIN THE JURISDICTION OF THE CITY OF MENLO PARK AND SHALL BE PERFORMED IN ACCORDANCE WITH THE PROVISIONS AND THE REQUIREMENTS OF THE ENCROACHMENT PERMITS.
- THE LOCATIONS AND TYPES OF EXISTING UTILITIES SHOWN ON THE IMPROVEMENT PLANS ARE BASED ON INFORMATION FURNISHED BY SERVICING AGENCIES AND IS TO BE SUPPLEMENTED BY ACTUAL FIELD INVESTIGATION AND VERIFICATIONS BY CONTRACTOR. ATTENTION IS DIRECTED TO VERIFICATIONS OF DEPTHS AND EXACT LOCATIONS OF EXISTING SERVICES WHETHER SHOWN ON THE PLAN OR NOT, AND THE CONTRACTOR SHALL TAKE PRECAUTIONARY MEASURES TO PRESERVE AND AVOID DAMAGES TO EXISTING UTILITIES ENCOUNTERED. CONTRACTOR SHALL NOTIFY PG&E, AT&T, COMCAST, ZAYO/VERIZON, CARGILL, SILICON VALLEY CLEAN WATER, CALTRANS, CITY OF MENLO PARK, AND UNDERGROUND SERVICE ALERT (USA) AT (800) 642-2444, PRIOR TO ANY FIELD INVESTIGATION.
- BEDDING MATERIAL SHALL BE AN IMPORTED VIRGIN GRANULAR MATERIAL FREE FROM VEGETABLE MATTER AND OTHER ORGANIC SUBSTANCES AND SHALL BE OF SUCH NATURE THAT IT CAN BE COMPACTED READILY UNDER WATERING, ROLLING AND TAMPING TO FORM A FIRM AND STABLE BASE. BEDDING MATERIAL SHALL CONFORM TO THE GRADATION REQUIREMENTS SHOWN ON THE DETAIL DRAWING.
- RELATIVE COMPACTION AND IN-PLACE DENSITY SHALL BE DETERMINED AS DEFINED BY THE TEST METHOD OF ASTM D1557.
- EXISTING FLOWS MUST BE MAINTAINED BY CONTRACTOR AT ALL TIMES DURING CONSTRUCTION. CONTRACTOR SHALL NOTIFY PROPERTY OWNERS OF ANY INTERRUPTION OF SEWER SERVICES PRIOR TO ANY WORK ON EXISTING SEWER PIPES. SEWAGE FLOWS SHALL BE MAINTAINED BY PUMPING.
- ALL EXISTING IMPROVEMENTS, INCLUDING BUT NOT LIMITED TO LANDSCAPING, DRIVEWAYS, CURB, GUTTER, SIDEWALK, CULVERTS, DRAINS, STRIPING (PAINTED OR THERMOPLASTIC) AND MONUMENTS, SHALL BE RESTORED TO THE CONDITION IN WHICH THEY WERE OR BETTER BEFORE THE EXCAVATION WAS MADE. PAYMENT FOR RESTORATION OF EXISTING IMPROVEMENTS TO THEIR ORIGINAL CONDITION WILL NOT BE MADE AND SHALL BE CONSIDERED AS INCLUDED IN THE VARIOUS CONTRACT ITEMS OF WORK INVOLVED.
- THE CONTRACTOR SHALL COMPLY WITH ALL RELEVANT PROVISIONS OF FEDERAL, STATE, AND LOCAL CODES AND REGULATIONS IN REGARD TO TRAFFIC CONTROL. THE CONTRACTOR SHALL SUBMIT A TRAFFIC CONTROL PLAN PRIOR TO THE START OF WORK TO BE APPROVED BY THE DISTRICT AND THE LOCAL JURISDICTION.
- THE CONTRACTOR SHALL CONDUCT THEIR OPERATION AS TO OFFER THE LEAST POSSIBLE OBSTRUCTION AND INCONVENIENCE TO THE PUBLIC. THROUGHOUT THE PERFORMANCE OF THE WORK, OR IN CONNECTION TO THIS CONTRACT, THE CONTRACTOR SHALL CONSTRUCT AND ADEQUATELY MAINTAIN SUITABLE AND SAFE CROSSINGS OVER TRENCHES, DRIVEWAY ACCESS AND SUCH DETOURS AS ARE NECESSARY TO CARE FOR PUBLIC PEDESTRIAN TRAFFIC.
- CONTRACTOR SHALL CONFORM TO ALL APPLICABLE OSHA RULES, REGULATIONS, AND ORDERS ESTABLISHED BY FEDERAL AND STATE AGENCIES BEFORE ENTERING SANITARY SEWER MANHOLES.
- IF THE CONTRACTOR PLANS TO USE MACHINERY WITH TRACKS, PLYWOOD SHALL BE PLACED IN FRONT AND/OR BACK OF THE MACHINE (DEPENDING ON THE TRAVEL DIRECTION), SO THAT SURFACE DESTRUCTION IS AVOIDED. ANY SURFACE DESTRUCTION SHALL BE REPAIRED BY THE CONTRACTOR AT NO COST TO THE DISTRICT, TO THE SATISFACTION OF THE LOCAL JURISDICTION.
- THE REPLACEMENT OF SEWER MAINS SHALL BE CONSTRUCTED AT THE DESIGNED HORIZONTAL ALIGNMENT AND THE PROPOSED GRADE (DEPTH) AS SHOWN ON THE PLANS. THE CONTRACTOR SHOULD BE ALERTED TO THE NEED FOR EXCAVATION BELOW EXISTING PIPE INVERT FOR PLACEMENT OF BEDDING MATERIALS AS SHOWN ON THE DETAIL DRAWINGS.
- CONCRETE FOR MANHOLES SHALL MEET THE REQUIREMENTS OF CLASS 1 CONCRETE AS DEFINED IN CALTRANS STANDARD SPECIFICATIONS, LATEST EDITION.
- CONTRACTOR SHALL PROVIDE PUMPS OR OTHER MEANS TO PREVENT SEWER WASTE BACKUP DUE TO THEIR WORK ON THE EXISTING SEWERS. CONTRACTOR SHALL BE RESPONSIBLE FOR CLEANUP AND DAMAGES CAUSED BY THEIR NEGLIGENCE, AND SHALL PAY ANY FINES DUE TO THEIR NEGLIGENCE.
- PRIOR TO THE START OF SEWER CONSTRUCTION, THE CONTRACTOR SHALL PERFORM BYPASSING OPERATIONS. CONSTRUCTION CAN NOT BEGIN UNTIL BYPASSING OPERATIONS ARE APPROVED BY THE DISTRICT.
- THE CONTRACTOR SHALL AT ALL TIMES HAVE AT THE JOB SITE SUFFICIENT PUMPING MACHINERY READY FOR IMMEDIATE USE. THE TRENCHES AND EXCAVATIONS SHALL BE KEPT ENTIRELY FREE OF WATER WHILE CONCRETE IS BEING POURED OR PIPE IS BEING LAID AND UNTIL CONCRETE OR MORTAR HAS SET HARD. WATER SHALL BE DISPOSED OF IN SUCH A MANNER AS WILL NOT CAUSE INJURY TO PUBLIC OR PRIVATE PROPERTY, NOR BE A MENACE TO PUBLIC HEALTH.

UNAUTHORIZED CHANGES & USES: The engineer preparing these plans will not be responsible for, or liable for, unauthorized changes to or uses of these plans. All changes to the plans must be in writing and must be approved by the preparer of these plans.

Construction contractor agrees that in accordance with generally accepted construction practices, construction contractor will be required to assume sole and complete responsibility for job site conditions during the course of construction of the project, including safety of all persons and property; that this requirement shall be made to apply continuously and not be limited to normal working hours, and construction contractor further agrees to defend, indemnify and hold design professional harmless from any and all liability, real or alleged, in connection with the performance of work on this project, excepting liability arising from the sole negligence of design professional.

#### BOARD OF DIRECTORS

FRAN DEHN	PRESIDENT
DAVID WALKER	SECRETARY
ROY THIELE-SARDIÑA	TREASURER
EDWARD P. MORITZ	DIRECTOR
GEORGE OTTE	DIRECTOR
SERGIO RAMIREZ	DISTRICT MANAGER

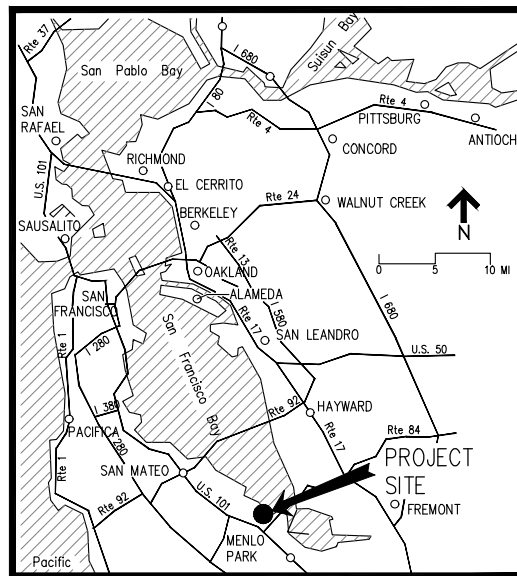

REGIONAL LOCATION NTS

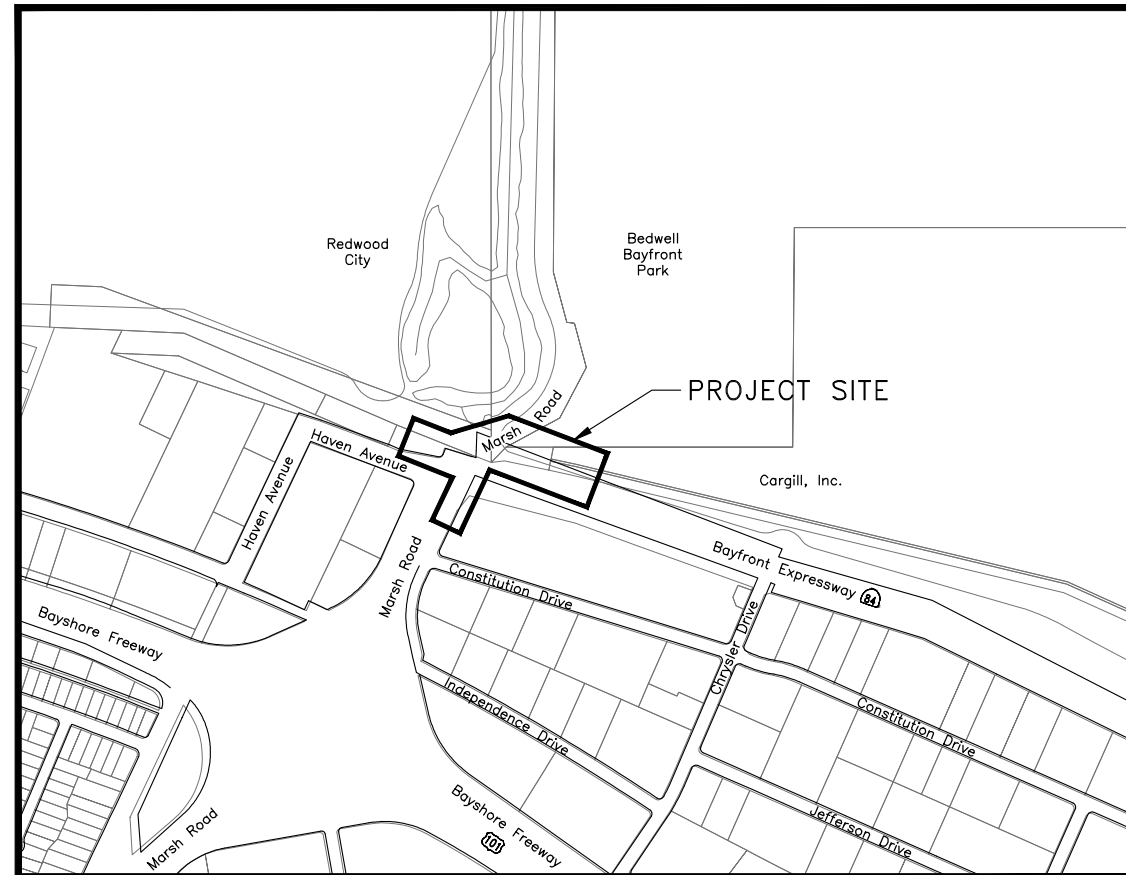

MENLO PARK VICINITY LOCATION NTS

#### LEGEND

SS/SSFM	PROPOSED SS/SSFM	EX. ACCESSIBLE RAMP	EX. SEWER MANHOLE	EX. TREE WITH DRIPLINE
COMM	PROPOSED COMMUNICATION	EX. AREA LIGHT	EX. WATER METER	EX. TRAFFIC SIGNAL
RW	PROPOSED RECYCLED WATER	EX. BACK FLOW PREVENTOR	EX. WATER VALVE	EX. TRAFFIC SIGNAL
SS	EXISTING SANITARY SEWER	EX. BENCHMARK	EX. STREET SIGN	EX. FENCE
GAS	EXISTING GAS LINE	EX. BOLLARD	EX. JOINT UTILITY POLE	EX. CURB AND GUTTER
OH	EXISTING OVERHEAD ELECTRICAL	EX. ELECTRICAL BOX	EX. STREET LIGHT	EX. STRIPING
W	EXISTING WATER	EX. FIRE HYDRANT	EX. STREET LIGHT BOX	EX. CONTOUR LINE
W	EXISTING BRINE WATER	EX. FIRE DEPT. CONNECTION	EX. STORM DRAIN INLET	
TEL	EXISTING STORM DRAIN	EX. GAS METER	EX. SURVEY POINT W/ DESCRIPTION AND GRADE	
TEL	EXISTING COMMUNICATION	EX. GAS VALVE	EX. SURVEY CONTROL POINT	
---	EXISTING EASEMENT	EX. GUY WIRE ANCHOR	EX. SURVEY MONUMENTS FOUND	
---	EXISTING RIGHT-OF-WAY/ PARCEL LINE	EX. IRRIGATION CONTROL BOX	EX. SURVEY MONUMENTS SET	

DATE:	09/07/2022	09/07/2022	BID SET
SCALE:	AS NOTED		
DESIGNED:	LFH & IRP		
DRAWN:	IRP		
CHECKED:	LFH		
PROJ. ENGR:	RJL		
BY	DATE	DESCRIPTION OF REVISIONS	APP'D

**FL FREYER & LAURETA, INC.**  
CIVIL ENGINEERS • SURVEYORS • CONSTRUCTION MANAGERS

150 Executive Park Blvd • San Francisco, CA 94134  
(415)534-7070 • www.freyerlaureta.com

**WEST BAY SANITARY DISTRICT**  
SAN MATEO COUNTY

PROJECT No. 1761.8



**BAYFRONT PARK SANITARY SEWER IMPROVEMENT PROJECT**  
**COVER SHEET**  
**MENLO PARK, CALIFORNIA**

SHEET  
0  
JOB NO.  
1088

**CONSTRUCTION NOTES:**

THE FOLLOWING CONTROL MEASURES FOR CONSTRUCTION ACTIVITIES SHALL BE ADHERED TO, UNLESS OTHERWISE APPROVED BY THE CITY ENGINEER.

1. CONTRACTOR SHALL BE RESPONSIBLE FOR THE DISPOSAL OF ANY EXCESS MATERIALS FROM THE WORK SITE.
2. EROSION CONTROL MEASURES SHALL BE INSTALLED AS NECESSARY TO PREVENT SEDIMENT RUNOFF TO PUBLIC ROADWAY DRAINAGE FACILITIES, ADJACENT PROPERTIES AND THE SAN FRANCISCO BAY.
3. CONTRACTOR SHALL BE RESPONSIBLE FOR ANY DAMAGES ON OR OFF THE PROJECT SITE AS A RESULT OF LACK OF DUST CONTROL.
4. DURING THE PROGRESS OF THE CONSTRUCTION WORK THE CONTRACTOR SHALL MAINTAIN THE PREMISES IN A NEAT AND CLEAN CONDITION, DISPOSING OF REFUSE IN A SATISFACTORY MANNER AS OFTEN AS DIRECTED OR AS MAY BE NECESSARY SO THAT THERE SHALL BE AT NO TIME ANY UNSIGHTLY ACCUMULATION OF RUBBISH AT THE JOB SITE.
5. CONTRACTOR TO ADHERE TO ALL REQUIREMENTS OF THE SAN MATEO COUNTY HEALTH SERVICES AGENCY.
6. STORAGE OF CONSTRUCTION MATERIALS AND EQUIPMENT WILL NOT BE ALLOWED IN OR UPON THE PUBLIC RIGHT-OF-WAY. ALL MATERIALS INTENDED FOR USE ON ANY PROJECT SHALL BE OFF LOADED DIRECTLY FROM DELIVERY VEHICLES AND PLACED AS REQUIRED DURING THE COURSE OF CONSTRUCTION. SHOULD THE PERMIT HOLDER OR SUB- CONTRACTORS WISH TO STOCKPILE MATERIALS NEAR THE WORK SITE, THEY SHALL MAKE ARRANGEMENTS IN ADVANCE FOR STORAGE. ALL STORAGE SITES SHALL BE SECURE, INACCESSIBLE TO THE GENERAL PUBLIC AND KEPT FREE OF CONSTRUCTION SPOILS, DEBRIS AND TRASH AT ALL TIMES. STORAGE SITES SHALL BE SUBJECT TO THE REVIEW AND APPROVAL OF THE CITY ENGINEER.
7. CONTRACTOR SHALL COMPLY WITH THE RULES AND REGULATIONS OF THE STATE CONSTRUCTION SAFETY ORDERS.
8. THE CONTRACTOR SHALL PROVIDE ALL LIGHTS, SIGNS, BARRICADES, FLAG MEN OR OTHER DEVICES NECESSARY TO PROVIDE FOR PUBLIC SAFETY & TRAFFIC CONTROL.
9. THE CONTRACTOR SHALL POST EMERGENCY TELEPHONE NUMBERS FOR POLICE, FIRE, AMBULANCE, AND THOSE AGENCIES RESPONSIBLE FOR MAINTENANCE OF UTILITIES IN THE VICINITY OF JOB SITE.
10. THE CONTRACTOR SHALL IMMEDIATELY REPORT ANY SOIL OR WATER CONTAMINATION NOTICED DURING CONSTRUCTION TO THE CITY OF MENLO PARK FIRE DEPARTMENT HAZARDOUS MATERIALS DIVISION, THE SAN MATEO COUNTY DEPARTMENT OF HEALTH, AND THE CALIFORNIA REGIONAL WATER QUALITY CONTROL BOARD.
11. THE CONTRACTOR SHALL BE RESPONSIBLE FOR ANY DAMAGE TO THE SITE OR SURROUNDING AREA DUE TO DUST OR EROSION, RESULTING FROM WORK DONE BY THE CONTRACTOR. CONTRACTOR SHALL PROVIDE A SEVEN (7) DAY PHONE NUMBER TO RECEIVE AND RESPOND TO DUST COMPLAINTS RESULTING FROM ALL CONSTRUCTION OPERATIONS AND SHALL BE MAINTAINED UNTIL CONSTRUCTION IS COMPLETE. ALL BUSINESSES AND RESIDENTS WITHIN 300' OF THE PROJECT SHALL BE NOTIFIED BY THE CONTRACTOR BY MAIL WITH INFORMATION AND COMPLAINT LINES TO BE CALLED.
12. CONTRACTOR IS TO MAINTAIN ALL JOB SITE FACILITIES UNTIL ACCEPTED BY THE CITY.
13. ALL EXCAVATION SPOILS SHALL BE PLACED DIRECTLY INTO TRUCKS AND DISPOSED OF AT AN APPROVED DUMPSITE.
14. CONSTRUCTION HOURS IN THE CITY PUBLIC RIGHT-OF-WAY ARE LIMITED TO WEEKDAYS AND NON-CITY HOLIDAYS BETWEEN 8:00AM TO 5:00PM.
15. CONTRACTOR IS RESPONSIBLE FOR REPLACING ANY DAMAGED OR DISRUPTED STRIPING IN-KIND.
16. PETROMAT MAY BE FOUND IN THE AC. CONTRACTOR IS RESPONSIBLE FOR REMOVAL AND PROPER DISPOSAL.
17. ALL CURB AND GUTTER REPLACED SHALL HAVE A 2 FOOT SAWCUT CONFORM, UNLESS OTHERWISE NOTED ON PLANS.
18. SURVEY ELEVATIONS SHOWN ARE BASED ON ASSUMED BENCHMARKS. ELEVATIONS DO NOT RELATE TO SEA LEVEL.
19. CONTRACTOR SHALL ADJUST ALL EXISTING SURFACE UTILITY FEATURES FOR ASPHALT AND CONCRETE REPAVING. UPON COMPLETION, UTILITY FEATURES SHALL BE SET FLUSH WITH NEW SURFACE GRADE. ADJUSTMENT OF ALL EXISTING SURFACE UTILITY FEATURES SHALL BE INCLUDED IN CONTRACTORS PRICE WHETHER OR NOT SPECIFICALLY CALLED OUT ON THE PLANS.
20. CONTRACTOR SHALL ACCOUNT FOR NECESSARY GROUNDWATER CONTROL.

**UNDERGROUND NOTES:**

1. SUBGRADE SHALL BE COMPACTED TO AT LEAST 95% RELATIVE COMPACTION. WHERE SUBGRADE CAN NOT BE COMPACTED TO 95% REMEDIAL METHODS SHOWN SHALL BE INCORPORATED IN THE WORK.
2. WHERE UNSUITABLE SUBGRADE MATERIAL IS ENCOUNTERED, REMEDIAL WORK TO BE DONE UNDER THE DIRECTION OF THE CITY ENGINEER, INCLUDES BUT IS NOT LIMITED TO, REMOVING UNSUITABLE MATERIAL AND PLACING A LAYER OF GEOTECHNIC FABRIC AND CLASS 2 AGGREGATE BASE COMPACTED TO 95% UNDER THE INSTALLATION.
3. OVER-EXCAVATED SUBGRADE FOR GUTTER OR SIDEWALK SHALL BE BACK-FILLED WITH CLASS 2 AGGREGATE BASE MATERIAL.
4. EXISTING CONCRETE SHALL BE REMOVED AT EXPANSION OR WEAKENED PLANE JOINTS BY SAWCUTTING.
5. SAW CUTS MUST BE FULL DEPTH.
6. NEW WORK SHALL MATCH EXISTING IN SCORE AND COLOR.
7. SUBGRADE SHALL BE THOROUGHLY WETTED IMMEDIATELY PRIOR TO PLACING CONCRETE.
8. SEE PROJECT SPECIFICATIONS FOR CONCRETE TYPE AND FINISHES.
9. CONCRETE SHALL HAVE A SLUMP OF NOT MORE THAN 4 INCHES.
10. NO ADMIXTURES SHALL BE USED WITHOUT THE PERMISSION OF THE CITY ENGINEER.
11. 1/2-INCH THICK EXPANSION JOINTS SHALL BE PLACED ON BOTH SIDES OF DRIVEWAY APPROACHES, CURB, GUTTER AND SIDEWALK RETURN POINTS AND AT 20' FEET ON CENTER.
12. WEAKENED PLANE JOINTS AT LEAST 1-1/2 INCHES DEEP SHALL BE PLACED AT THE CENTER OF DRIVEWAYS AND 20' ON CENTER.
13. 1/4-INCH DEEP SCORE MARKS SHALL BE PLACED AS DESCRIBED IN THE STANDARD SPECIFICATIONS OR AS DIRECTED BY THE CITY ENGINEER.
14. NO CONCRETE SHALL BE PLACED UNTIL THE CITY ENGINEER OR HIS AUTHORIZED REPRESENTATIVE HAS INSPECTED AND APPROVED FORMS AND SUBGRADE.
15. ALL EXPOSED EDGES SHALL BE ROUNDED WITH 1/2-INCH RADIUS TOOL.
16. ALL SURFACES SHALL BE BROOM FINISHED FOR CURB AND GUTTER. REFER TO PROJECT SPECIFICATIONS FOR FLATWORK AND OTHER CONCRETE IMPROVEMENTS FINISHES.
17. CURBS, SIDEWALKS AND DRIVEWAY APPROACHES SHALL BE BACK FILLED WITHIN 7 DAYS AFTER PLACING CONCRETE. THIS SHALL INCLUDE ANY REQUIRED AC PATCHWORK.
18. FORM FACES SHALL NOT VARY FROM THE DIMENSIONS SHOWN BY MORE THAN .02 FEET. FORMS SHALL MEET GRADE.
19. UNLESS OTHERWISE SPECIFIED ON THE APPROVED PLANS, CONCRETE SHALL BE CURED BY MEANS OF THE IMPERVIOUS MEMBRANE METHOD.
20. ALL WORK WITHIN THE PUBLIC RIGHT-OF-WAY SHALL BE PERFORMED BY A STATE LICENSED "CLASS A" CONTRACTOR. A CONCRETE CONTRACTOR WITH A "C" LICENSE MAY PERFORM CONCRETE FLAT WORK.
21. A MINIMUM OF 12" OF ASPHALT SHALL BE REMOVED ALONG THE GUTTER LIP FOR THE INSTALLATION OF FORMS. FOR CURB AND GUTTER INSTALLATIONS AC SHALL BE BROUGHT TO FINISH GRADE OF FORMS AND TRANSITIONED AS REQUIRED BY THE CITY ENGINEER.
22. ALL ASPHALT REPAIRS SHALL BE FLUSH WITH THE ADJACENT SURFACES AT CONFORMS AND EDGES. MAXIMUM ALLOWABLE TOLERANCES SHALL BE .01' LONGITUDINALLY AND .02' TRANSVERSELY.
23. ALL DRIVEWAYS, CURB AND GUTTER, AND SIDEWALK REPLACEMENTS SHALL BE PER CITY STANDARDS. CONTRACTOR IS RESPONSIBLE FOR UNDERSTANDING THESE DETAILS FOR PROPER BIDDING AND INSTALLATION.

**CONCRETE GENERAL NOTES:**

1. LOCATIONS OF EXISTING UNDERGROUND FACILITIES AND UTILITIES SHOWN ARE BASED ON AVAILABLE UTILITY COMPANY INFORMATION. IT IS THE CONTRACTOR'S RESPONSIBILITY TO VERIFY THE ACTUAL LOCATION OF UTILITIES PRIOR TO THE COMMENCEMENT OF WORK. THE CONTRACTOR SHALL CONTACT UNDERGROUND SERVICE ALERT (U.S.A.) AT (800)227-2600 AT LEAST 48 HOURS IN ADVANCE OF ANY EXCAVATING.
2. PHYSICAL VERIFICATION OF UTILITY LOCATION SHALL BE PERFORMED BY POT HOLING OR HAND DIGGING AND CAREFUL SUBSURFACE PROBING IN CONFORMANCE WITH ARTICLE 6 OF THE CAL/OSHA CONSTRUCTION SAFETY ORDERS. ANY DEVIATIONS FROM LOCATIONS SHOWN ON PLANS SHALL BE BROUGHT TO THE ENGINEER'S ATTENTION BEFORE STARTING CONSTRUCTION.
3. EXISTING UTILITIES ARE SHOWN PER AVAILABLE INFORMATION. THERE MAY BE ADDITIONAL EXISTING LINES NOT SHOWN ON THE PLANS. CONTRACTOR SHALL BE CAREFUL TO AVOID ANY DAMAGE TO THESE UTILITY SERVICES.
4. ALL EXISTING UTILITIES AND IMPROVEMENTS THAT BECOME DAMAGED DURING CONSTRUCTION SHALL BE COMPLETELY RESTORED TO THE SATISFACTION OF THE CITY ENGINEER AND THE UTILITY OWNER AT THE CONTRACTOR'S SOLE EXPENSE.
5. MAIN UTILITIES, OTHER THAN WATER, SANITARY SEWER, AND STORM IN CONFLICT WITH THE WORK WILL BE RELOCATED BY OTHERS. WATER MAINS, SANITARY SEWER MAINS, STORM DRAINS AND THEIR SERVICES REQUIRED TO BE TEMPORARILY OR PERMANENTLY RELOCATED FOR CONSTRUCTION OF PROPOSED IMPROVEMENTS SHALL BE RELOCATED BY THE CONTRACTOR.

**ABBREVIATIONS**

AB	AGGREGATE BASE
AC	ASPHALT CONCRETE
APPROX	APPROXIMATE
ARV	AIR RELEASE VALVE
BW	BACK OF WALK
CDF	CONTROLLED DENSITY FILL
CIPP	CURED-IN-PLACE PIPE
CC	CONCRETE CYLINDER
CL	CENTER LINE
CLR	CLEAR
CMP	CORRUGATED METAL PIPE
COMM	COMMUNICATIONS
CONC	CONCRETE
CS	CLASS
CULV	CULVERT
DET	DETAIL
DIP	DUCTILE IRON PIPE
E	ELECTRIC
EL	ELEVATION
EX OR (E)	EXISTING
FC	FACE OF CURB
FL	FLOW LINE
FP	FINISHED PAVEMENT
FTG	FOOTING
FUT	FUTURE
FW	FRONT OF WALK
GB	GRADE BREAK
HP	HIGH POINT, HIGH PRESSURE
INV	INVERT ELEVATION
LF	LINEAR FEET
LT	LEFT
MAX	MAXIMUM
MIN	MINIMUM
(N)	NEW
OC	ON CENTER
RCP	REINFORCED CONCRETE PIPE
REQ'D	REQUIRED
RT	RIGHT
RW	RECYCLED WATER
S	SLOPE
SBSP	SOUTH BAY SALT PONDS
SD	STORM DRAIN
SDCB	STORM DRAIN CATCH BASIN
SF	SQUARE FEET
SS	SANITARY SEWER
SSFM	SANITARY SEWER FORCE MAIN
STA	STATION
STD	STANDARD
T	TELEPHONE
TC	TOP OF CURB
TEL	TELECOMMUNICATION
TYP (TYP)	TYPICAL
VCP	VITRIFIED CLAY PIPE
VIF	VERIFY IN FIELD
W	WATER
WSCL/C	WELDED STEEL CEMENT MORTAR LINED

DATE:	09/07/2022	09/07/2022	BID SET
SCALE:	AS NOTED		
DESIGNED:	LFH & IRP		
DRAWN:	IRP		
CHECKED:	LFH		
PROJ. ENGR:	RJL		
	BY	DATE	DESCRIPTION OF REVISIONS
			APP'D



150 Executive Park Blvd • San Francisco, CA 94134  
(415)534-7070 • www.freyerlaureta.com

**WEST BAY**  
SANITARY DISTRICT  
SAN MATEO COUNTY

PROJECT No. 1761.8



**BAYFRONT PARK SANITARY SEWER  
IMPROVEMENT PROJECT  
GENERAL NOTES  
MENLO PARK, CALIFORNIA**

SHEET

1

JOB NO.

1088

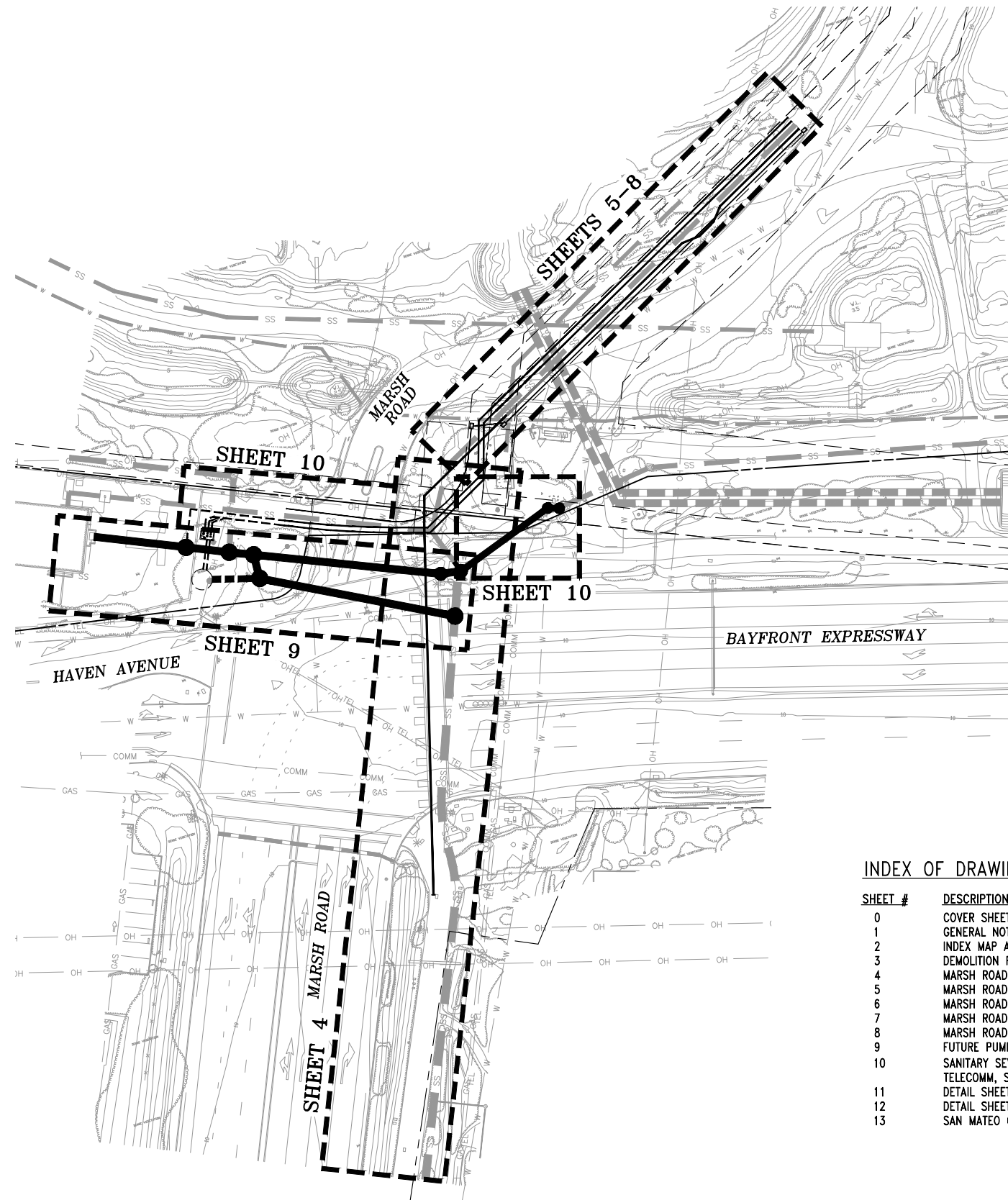

**INDEX OF DRAWINGS**

SHEET #	DESCRIPTION	
0	COVER SHEET	
1	GENERAL NOTES	
2	INDEX MAP AND INDEX LABEL	
3	DEMOLITION PLAN	
4	MARSH ROAD - RECYCLED WATER	STA 0+00 - STA 4+00
5	MARSH ROAD - RETURN SSFM	STA 5+00 - END
6	MARSH ROAD - SSFM	STA 5+00 - END
7	MARSH ROAD - RECYCLED WATER	STA 4+00 - END
8	MARSH ROAD - TELECOMMUNICATION	STA 5+00 - END
9	FUTURE PUMP STATION - SANITARY SEWER	STA 1+00 - STA 3+50
10	SANITARY SEWER (STA 3+50 - END), TELECOMM, SSFM, RETURN SSFM	
11	DETAIL SHEET #1	
12	DETAIL SHEET #2	
13	SAN MATEO COUNTY BMP	

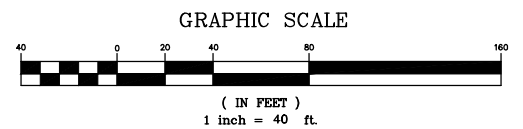

DATE:	09/07/2022	09/07/2022	BID SET
SCALE:	AS NOTED		
DESIGNED:	LFH & IRP		
DRAWN:	IRP		
CHECKED:	LFH		
PROJ. ENGR:	RJL		
BY	DATE	DESCRIPTION OF REVISIONS	APP'D

**FL FREYER & LAURETA, INC.**  
 CIVIL ENGINEERS • SURVEYORS • CONSTRUCTION MANAGERS

150 Executive Park Blvd • San Francisco, CA 94134  
 (415)534-7070 • www.freyerlaureta.com

**WEST BAY**  
 SANITARY DISTRICT  
 SAN MATEO COUNTY

PROJECT No. 1761.8







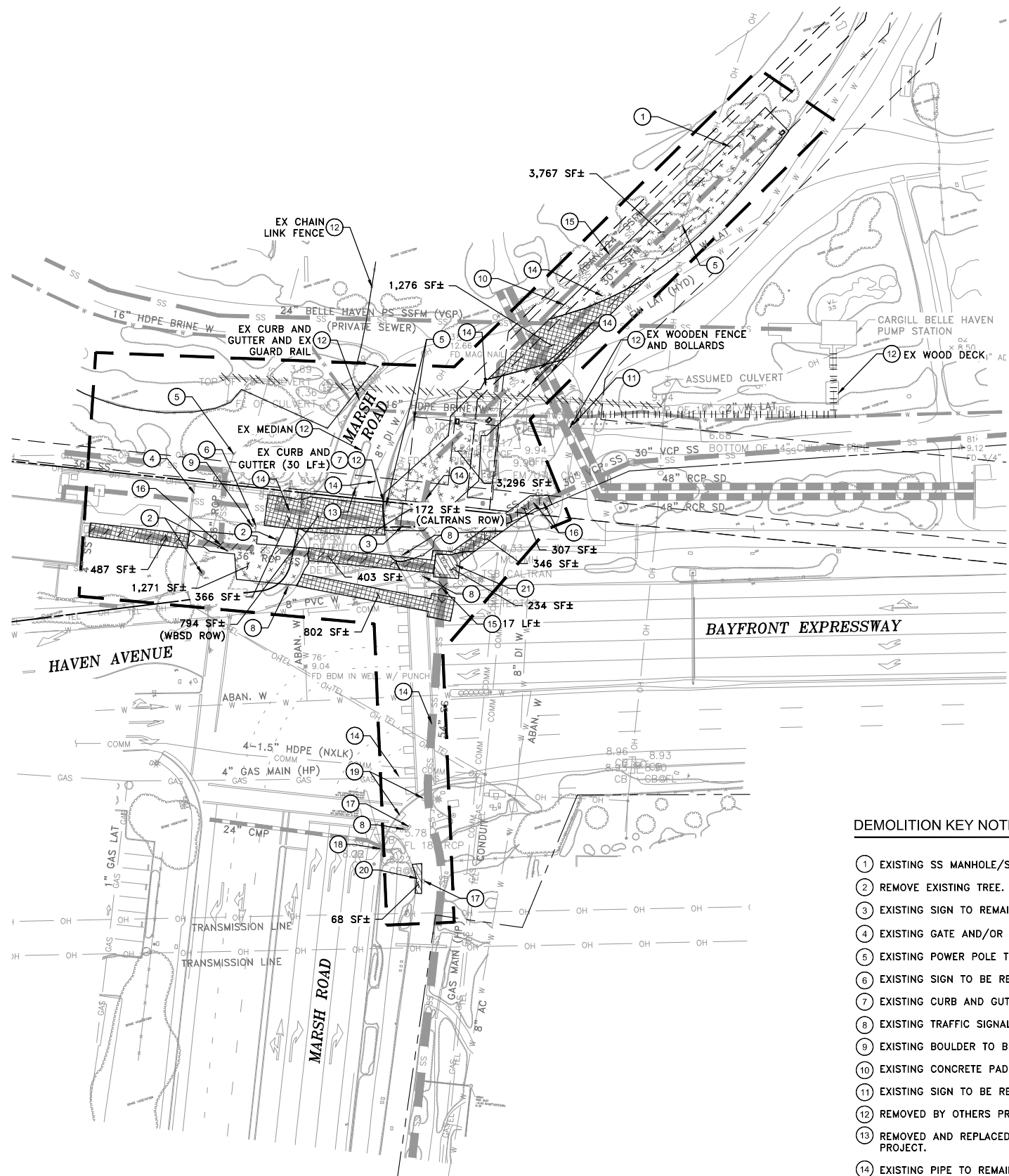

**BAYFRONT PARK SANITARY SEWER  
 IMPROVEMENT PROJECT**  
 INDEX MAP AND INDEX LABEL  
 MENLO PARK, CALIFORNIA

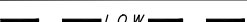
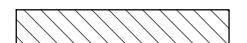
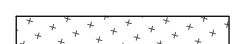
SHEET  
 2  
 JOB NO.  
 1088



**LEGEND**

- LIMIT OF WORK**  L.O.W.
- AREA TO BE DEMOLISHED** 
- CLEAR AND GRUB** 
- AC PAVEMENT CUT** 
- DEMOLITION NOTES** 
- EXISTING UTILITY TO BE REMOVED BY OTHERS PRIOR TO THE START OF THIS PROJECT** 
- SANITARY SEWER TO BE REPLACED** 
- EXISTING UTILITY TO BE REMOVED AND RELOCATED BY OTHERS PRIOR TO THE START OF THIS PROJECT** 
- EXISTING UTILITY TO BE REMOVED** 

**GENERAL NOTES**

- ALL EXISTING UTILITY INFORMATION HAS BEEN COMPILED FROM TOPOGRAPHIC SURVEY AND RECORD DRAWINGS. CONTRACTOR SHALL FIELD VERIFY EXACT LOCATIONS OF ALL SITE UTILITIES PRIOR TO DEMOLITION ACTIVITIES.
- CONTRACTOR SHALL CAP/PLUG OR REMOVE EXISTING UTILITIES SHOWN ON PLAN PER ACCEPTABLE CITY OF MENLO PARK/WEST BAY SANITARY DISTRICT STANDARDS AND APPROVED METHODS BY UTILITY AGENCIES.
- CONTRACTOR SHALL COORDINATE UNDERGROUND AND OVERHEAD UTILITY TERMINATION, RELOCATION, AND POLE REMOVAL WITH PG&E, AND/OR RESPECTIVE UTILITY AGENCY.
- ALL NEW FILL FOR BACKFILLING VOIDS SHALL BE AS SPECIFIED IN THE SPECIFICATIONS. FILL SHALL BE PLACED AND COMPACTED IN ACCORDANCE TO THE GEOTECHNICAL RECOMMENDATIONS.
- THICKNESS OF EXISTING CONCRETE SURFACES, FOUNDATION SLABS, AC PAVEMENT SURFACES, AND BASE MATERIAL IS UNKNOWN. CONTRACTOR SHALL FIELD VERIFY PRIOR TO DEMOLITION ACTIVITIES.
- CONTRACTOR SHALL PROTECT THE EXISTING ABOVE & UNDERGROUND UTILITIES AND IMPROVEMENTS AND PERMANENT ABOVE & UNDERGROUND IMPROVEMENTS AND UTILITIES WITHIN AND OUTSIDE THE LIMITS OF WORK DURING DEMOLITION AND GRADING ACTIVITIES.
- EXISTING TREES TO REMAIN UNLESS OTHERWISE NOTED.
- CONSTRUCTION OF SMC PW PROJECT BY OTHERS TO OCCUR PRIOR TO WBSD SEWER IMPROVEMENTS.
- CONTRACTOR TO POTHOLE EXISTING WBSD FACILITIES TO REMAIN AND REPORT TO ENGINEER OF RECORD PRIOR TO EXCAVATION.

**DEMOLITION KEY NOTES**

- EXISTING SS MANHOLE/STRUCTURE TO REMAIN.
- REMOVE EXISTING TREE.
- EXISTING SIGN TO REMAIN.
- EXISTING GATE AND/OR FENCE TO BE REMOVED AND REPLACED.
- EXISTING POWER POLE TO REMAIN. PROTECT IN PLACE.
- EXISTING SIGN TO BE REMOVED AND SALVAGED.
- EXISTING CURB AND GUTTER TO BE REMOVED AND REPLACED.
- EXISTING TRAFFIC SIGNAL TO REMAIN.
- EXISTING BOULDER TO BE RELOCATED.
- EXISTING CONCRETE PAD TO BE REMOVED.
- EXISTING SIGN TO BE REMOVED AND RELOCATED.
- REMOVED BY OTHERS PRIOR TO THIS PROJECT.
- REMOVED AND REPLACED SIGNS AND GATES BY OTHERS PRIOR TO THIS PROJECT.
- EXISTING PIPE TO REMAIN. PROTECT IN PLACE.
- EXISTING PIPE TO BE ABANDONED IN PLACE, SLURRY FILLED, AND PLUGGED AT BOTH ENDS.
- REMOVE AND REPLACE EXISTING SS MANHOLE/STRUCTURE.
- PROTECT EXISTING VAULT.
- PROTECT EXISTING CATCH BASIN.
- PROTECT EXISTING CURB RAMP.
- REMOVE AND REPLACE EXISTING SIDEWALK.
- REMOVE EXISTING JUNCTION BOX AND MANHOLE COVERS.

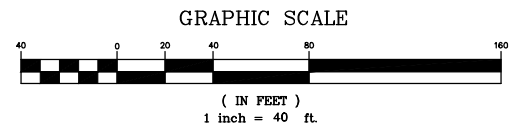

DATE:	09/07/2022	09/07/2022	BID SET
SCALE:	AS NOTED		
DESIGNED:	LFH & IRP		
DRAWN:	IRP		
CHECKED:	LFH		
PROJ. ENGR:	RJL		
BY	DATE	DESCRIPTION OF REVISIONS	APP'D

**FL FREYER & LAURETA, INC.**  
 CIVIL ENGINEERS • SURVEYORS • CONSTRUCTION MANAGERS

150 Executive Park Blvd • San Francisco, CA 94134  
 (415)534-7070 • www.freyerlaureta.com

**WEST BAY SANITARY DISTRICT**  
 SAN MATEO COUNTY

PROJECT No. 1761.8

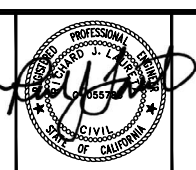

**BAYFRONT PARK SANITARY SEWER IMPROVEMENT PROJECT**  
**DEMOLITION PLAN**  
 MENLO PARK, CALIFORNIA

SHEET  
**3**

JOB NO.  
**1088**

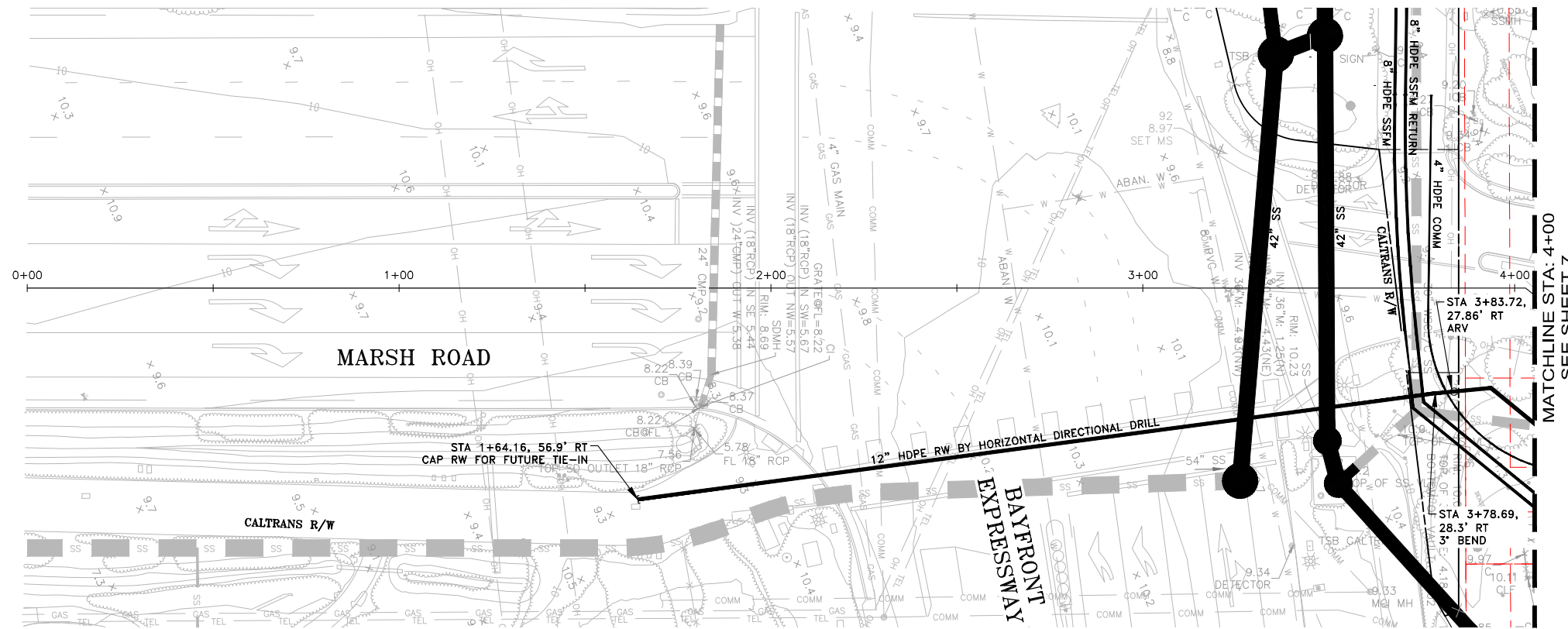

**NOTES:**

- 1) CONTRACTOR SHALL BE RESPONSIBLE FOR THE UNINTERRUPTION OF SEWER SERVICE FOR ALL PROPERTIES. CONTRACTOR SHALL SUBMIT BYPASS PLAN TO THE DISTRICT FOR APPROVAL 10 DAYS PRIOR TO THE PRE-CONSTRUCTION MEETING.
- 2) CONTRACTOR SHALL TAKE ALL NECESSARY PRECAUTIONS TO AVOID ANY DAMAGE TO EXISTING UTILITIES. CONTRACTOR SHALL NOTE THE CLOSE PROXIMITY OF UTILITIES TO PROPOSED IMPROVEMENTS. CONTRACTOR SHALL NOTIFY U.S.A. TO LOCATE UTILITIES AT THE PROJECT SITE PRIOR TO START OF CONSTRUCTION.
- 3) CONTACT CALTRANS FOR ANY WORK WITHIN THEIR RIGHT OF WAY AT LEAST 7 DAYS PRIOR.
- 4) ALL PROPERTY LINES SHOWN ARE APPROXIMATED FROM ASSESSORS PARCEL MAPS OR FROM RECORD INFORMATION, AND THEIR LOCATION MAY NOT BE EXACT.
- 5) CONTRACTOR TO INFORM PG&E OF WORK NEAR PG&E'S MAJOR FACILITIES A MINIMUM OF SEVEN WORKING DAYS PRIOR TO WORK IN THE AREA TO ENSURE A PG&E REPRESENTATIVE IS ONSITE TO OBSERVE THE WORK DONE.

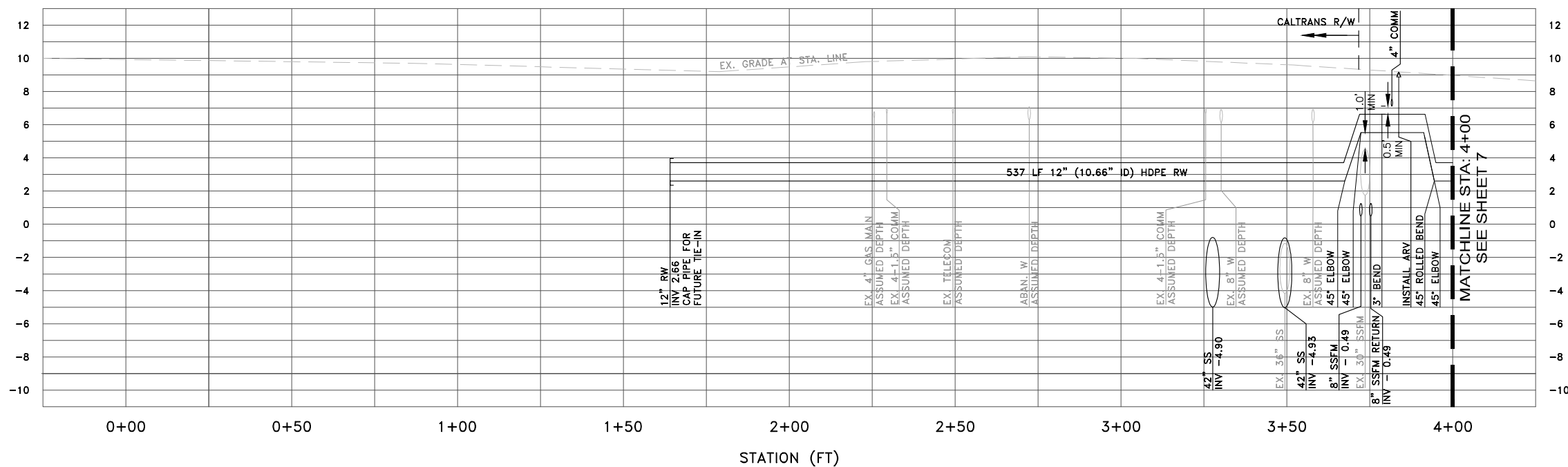
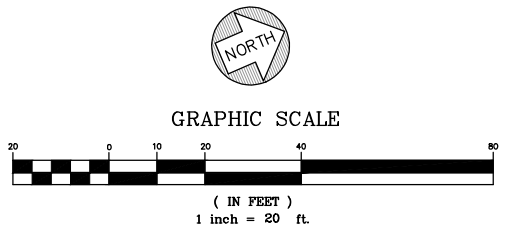

**PROFILE VIEW**  
 HORIZ: 1" = 20'  
 VERT: 1" = 4'

DATE:	09/07/2022	BID SET
SCALE:	AS NOTED	
DESIGNED:	LFH & IRP	
DRAWN:	IRP	
CHECKED:	LFH	
PROJ. ENGR:	RJL	
BY	DATE	DESCRIPTION OF REVISIONS
		APP'D



150 Executive Park Blvd • San Francisco, CA 94134  
 (415)534-7070 • www.freyerlaureta.com



PROJECT No. 1761.8



**BAYFRONT PARK SANITARY SEWER IMPROVEMENT PROJECT**  
**MARSH ROAD - RECYCLED WATER**  
**STA 0+00 - STA 4+00**  
**MENLO PARK, CALIFORNIA**

SHEET	4
JOB NO.	1088

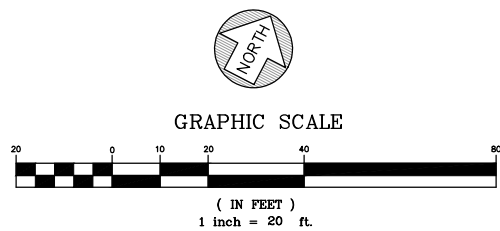
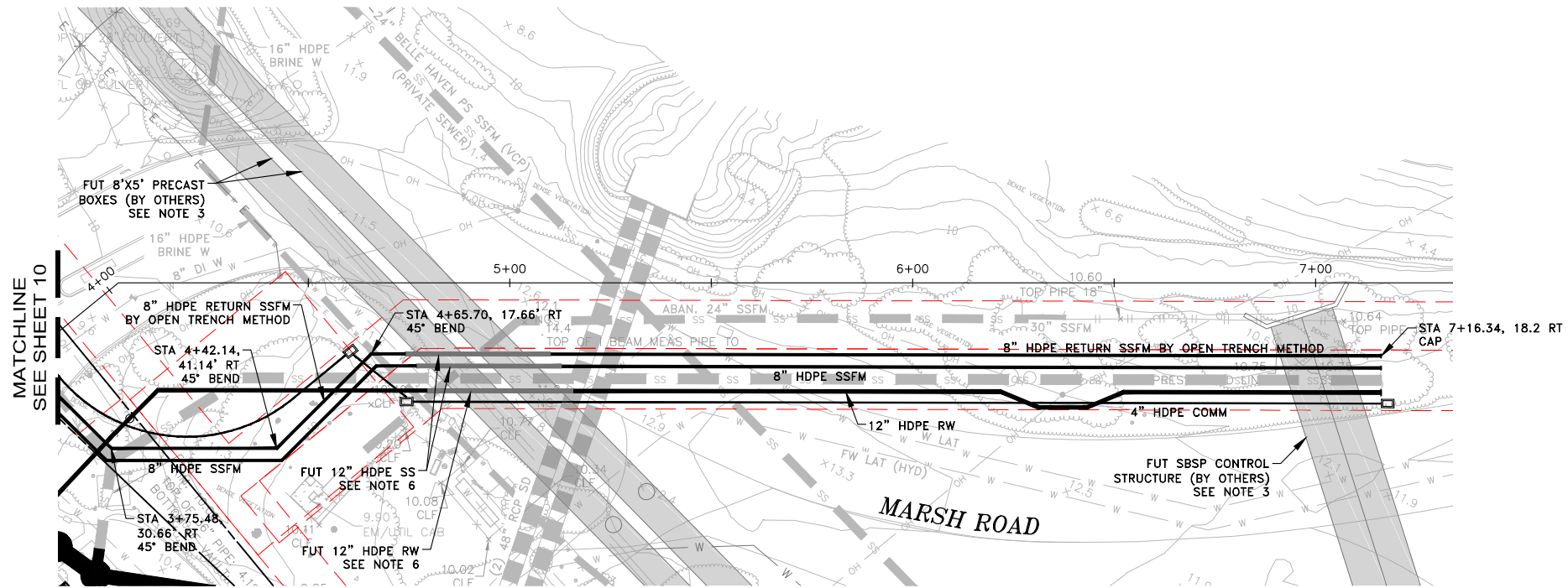

**NOTES:**

- 1) CONTRACTOR SHALL BE RESPONSIBLE FOR THE UNINTERRUPTION OF SEWER SERVICE FOR ALL PROPERTIES. CONTRACTOR SHALL SUBMIT BYPASS PLAN TO THE DISTRICT FOR APPROVAL 10 DAYS PRIOR TO THE PRE-CONSTRUCTION MEETING.
- 2) CONTRACTOR SHALL TAKE ALL NECESSARY PRECAUTIONS TO AVOID ANY DAMAGE TO EXISTING UTILITIES. CONTRACTOR SHALL NOTE THE CLOSE PROXIMITY OF UTILITIES TO PROPOSED IMPROVEMENTS. CONTRACTOR SHALL NOTIFY U.S.A. TO LOCATE UTILITIES AT THE PROJECT SITE PRIOR TO START OF CONSTRUCTION.
- 3) CONTRACTOR TO REFER TO AS-BUILTS FOR SOUTH BAY SALT PONDS (SBSP) PROJECT AND SAN MATEO COUNTY PUBLIC WORKS PROJECT PRIOR TO CONSTRUCTION.
- 4) ALL PROPERTY LINES SHOWN ARE APPROXIMATED FROM ASSESSORS PARCEL MAPS OR FROM RECORD INFORMATION, AND THEIR LOCATION MAY NOT BE EXACT.
- 5) CONTRACTOR TO INFORM PG&E OF WORK NEAR PG&E'S MAJOR FACILITIES A MINIMUM OF SEVEN WORKING DAYS PRIOR TO WORK IN THE AREA TO ENSURE A PG&E REPRESENTATIVE IS ONSITE TO OBSERVE THE WORK DONE.
- 6) IF SLEEVES ARE FOUND, CONTRACTOR SHALL REMOVE PRIOR TO INSTALLATION OF NEW SS, SSFM, AND RW PIPES.

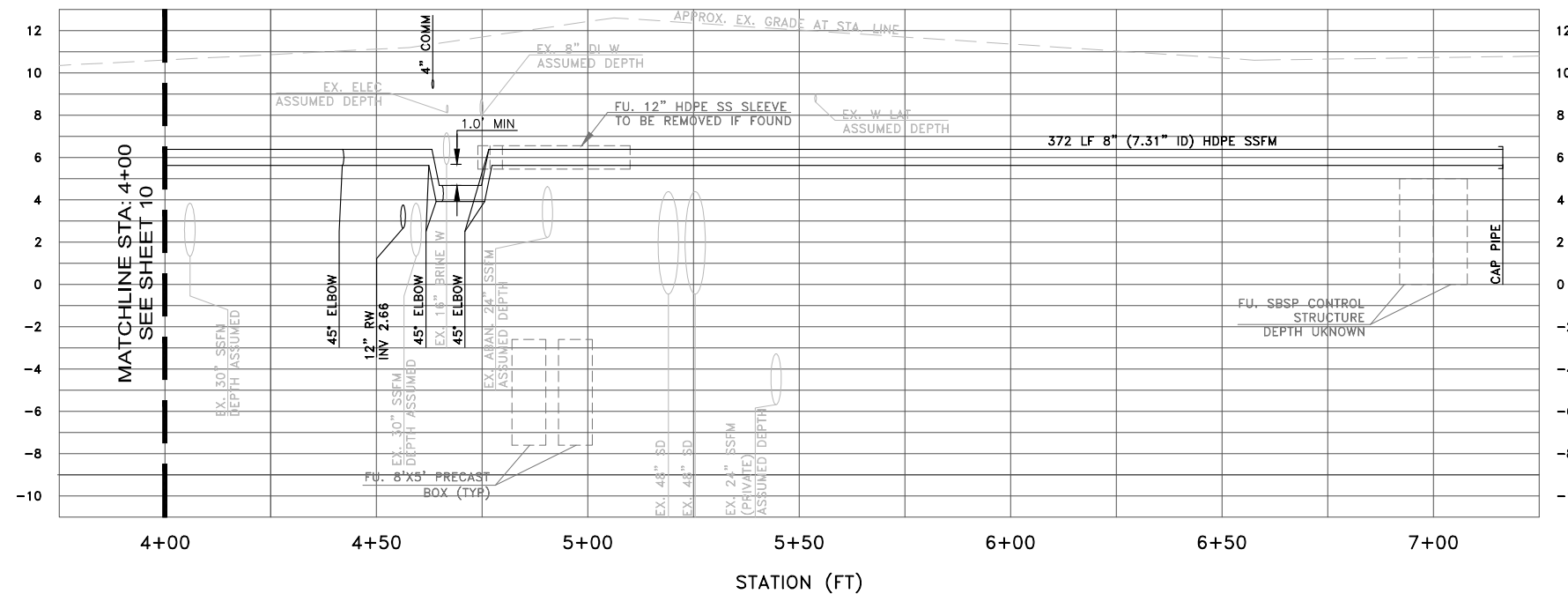

**PROFILE VIEW**  
 HORIZ: 1" = 20'  
 VERT: 1" = 4'

DATE: 09/07/2022	09/07/2022	BID SET	
SCALE: AS NOTED			
DESIGNED: LFH & IRP			
DRAWN: IRP			
CHECKED: LFH			
PROJ. ENGR: RJL			
BY	DATE	DESCRIPTION OF REVISIONS	APP'D



150 Executive Park Blvd. • San Francisco, CA 94134  
 (415)534-7070 • www.freyerlaureta.com

**WEST BAY**  
 SANITARY DISTRICT  
 SAN MATEO COUNTY

PROJECT No. 1761.8



**BAYFRONT PARK SANITARY SEWER  
 IMPROVEMENT PROJECT**  
**MARSH ROAD - RETURN SSFM**  
**MENLO PARK, CALIFORNIA**

SHEET  
 5  
 JOB NO.  
 1088

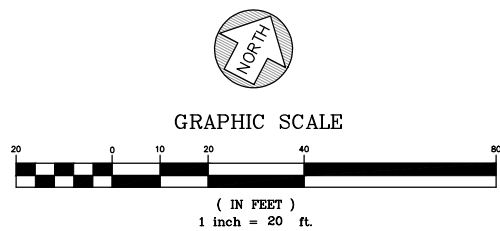
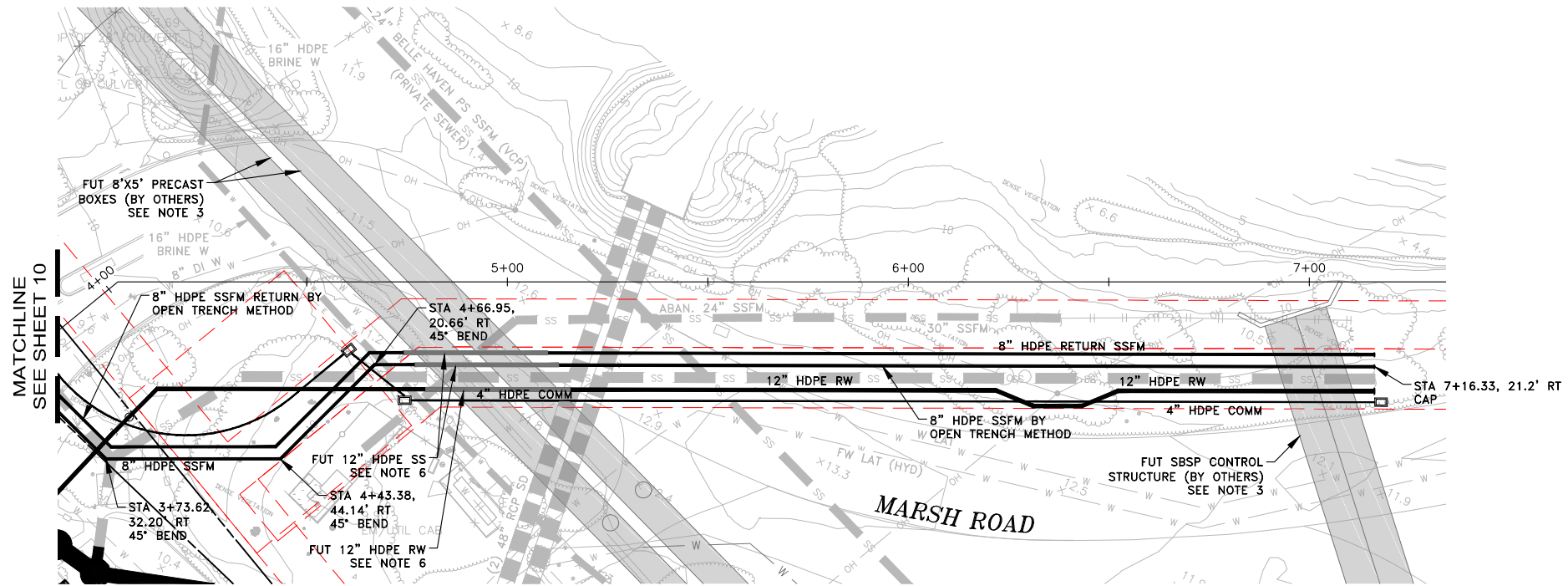

**NOTES:**

- 1) CONTRACTOR SHALL BE RESPONSIBLE FOR THE UNINTERRUPTION OF SEWER SERVICE FOR ALL PROPERTIES. CONTRACTOR SHALL SUBMIT BYPASS PLAN TO THE DISTRICT FOR APPROVAL 10 DAYS PRIOR TO THE PRE-CONSTRUCTION MEETING.
- 2) CONTRACTOR SHALL TAKE ALL NECESSARY PRECAUTIONS TO AVOID ANY DAMAGE TO EXISTING UTILITIES. CONTRACTOR SHALL NOTE THE CLOSE PROXIMITY OF UTILITIES TO PROPOSED IMPROVEMENTS. CONTRACTOR SHALL NOTIFY U.S.A. TO LOCATE UTILITIES AT THE PROJECT SITE PRIOR TO START OF CONSTRUCTION.
- 3) CONTRACTOR TO REFER TO AS-BUILTS FOR SOUTH BAY SALT PONDS (SBSP) PROJECT AND SAN MATEO COUNTY PUBLIC WORKS PROJECT PRIOR TO CONSTRUCTION.
- 4) ALL PROPERTY LINES SHOWN ARE APPROXIMATED FROM ASSESSORS PARCEL MAPS OR FROM RECORD INFORMATION, AND THEIR LOCATION MAY NOT BE EXACT.
- 5) CONTRACTOR TO INFORM PG&E OF WORK NEAR PG&E'S MAJOR FACILITIES A MINIMUM OF SEVEN WORKING DAYS PRIOR TO WORK IN THE AREA TO ENSURE A PG&E REPRESENTATIVE IS ONSITE TO OBSERVE THE WORK DONE.
- 6) IF SLEEVES ARE FOUND, CONTRACTOR SHALL REMOVE PRIOR TO INSTALLATION OF NEW SS, SSFM, AND RW PIPES.

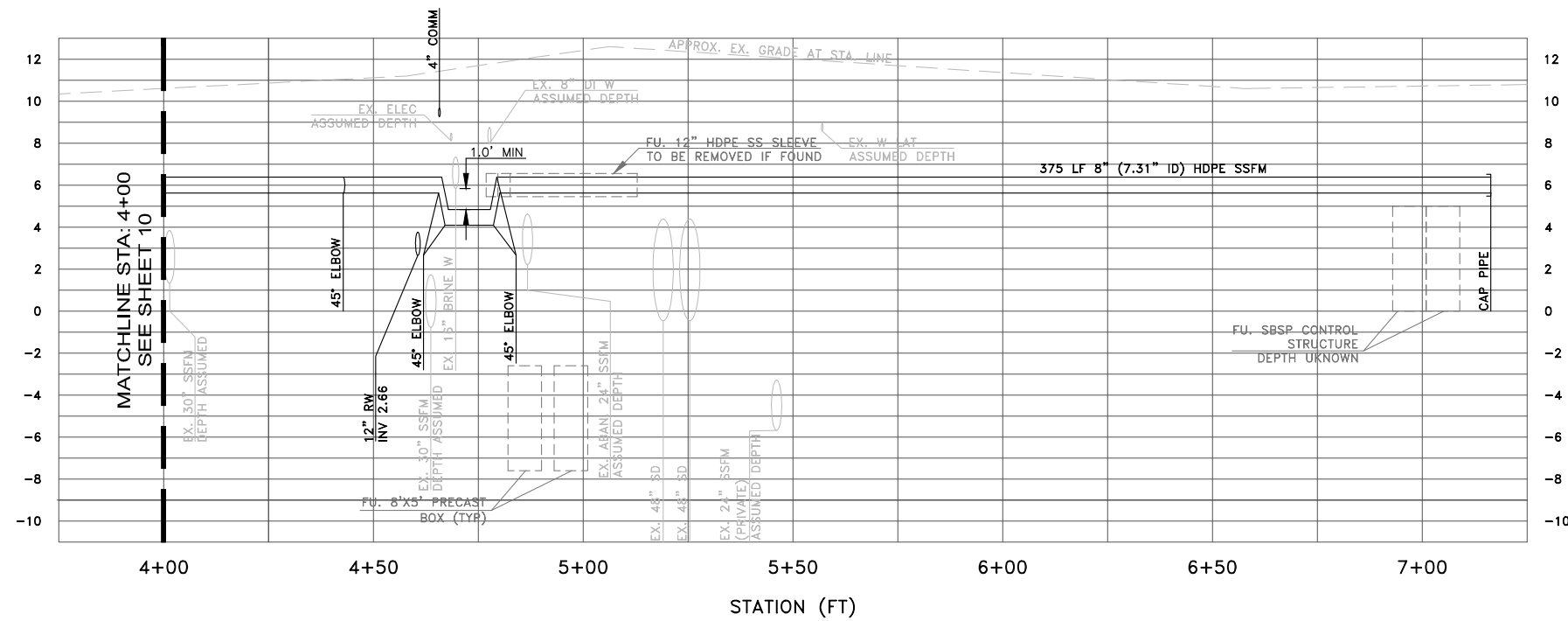

**PROFILE VIEW**  
 HORIZ: 1" = 20'  
 VERT: 1" = 4'

DATE: 09/07/2022	09/07/2022	BID SET	
SCALE: AS NOTED			
DESIGNED: LFH & IRP			
DRAWN: IRP			
CHECKED: LFH			
PROJ. ENGR: RJL			
BY	DATE	DESCRIPTION OF REVISIONS	APP'D



150 Executive Park Blvd. • San Francisco, CA 94134  
 (415)534-7070 • www.freyerlaureta.com

**WEST BAY**  
 SANITARY DISTRICT  
 SAN MATEO COUNTY

PROJECT No. 1761.8



**BAYFRONT PARK SANITARY SEWER  
 IMPROVEMENT PROJECT**  
**MARSH ROAD - SSFM**  
**MENLO PARK, CALIFORNIA**

SHEET  
 6  
 JOB NO.  
 1088

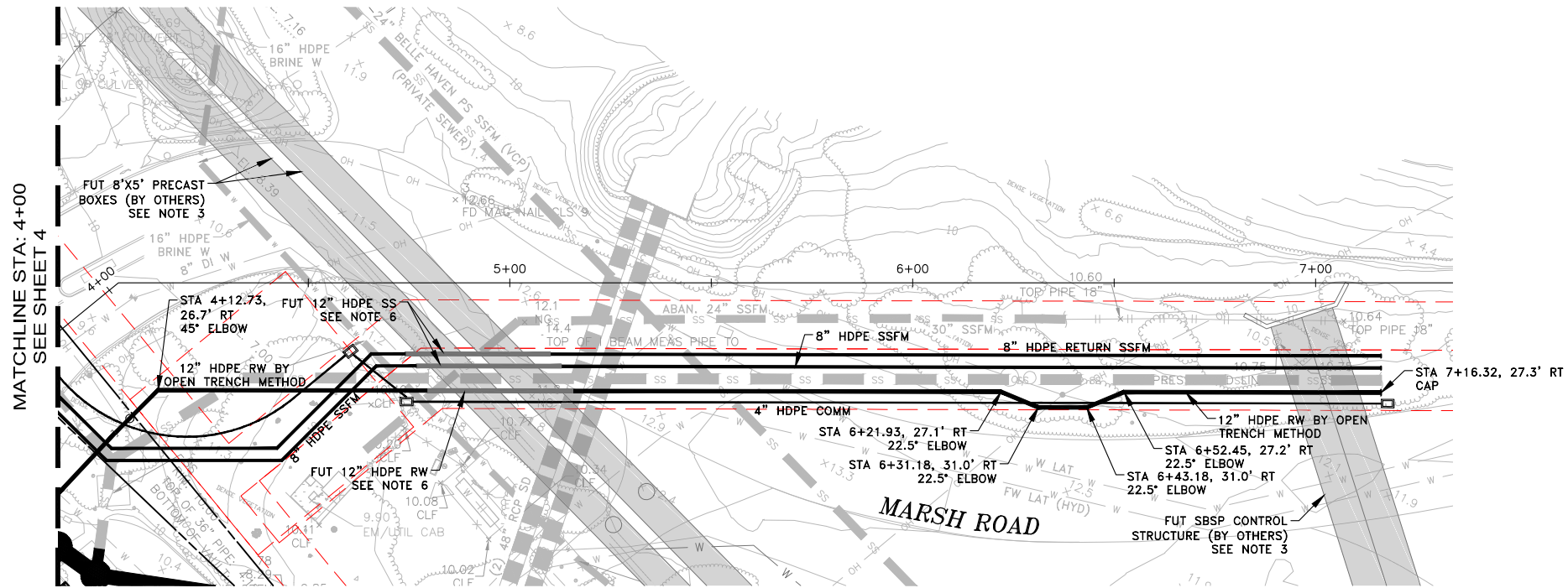

MATCHLINE STA: 4+00  
SEE SHEET 4



GRAPHIC SCALE

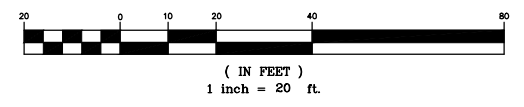

**NOTES:**

- 1) CONTRACTOR SHALL BE RESPONSIBLE FOR THE UNINTERRUPTION OF SEWER SERVICE FOR ALL PROPERTIES. CONTRACTOR SHALL SUBMIT BYPASS PLAN TO THE DISTRICT FOR APPROVAL 10 DAYS PRIOR TO THE PRE-CONSTRUCTION MEETING.
- 2) CONTRACTOR SHALL TAKE ALL NECESSARY PRECAUTIONS TO AVOID ANY DAMAGE TO EXISTING UTILITIES. CONTRACTOR SHALL NOTE THE CLOSE PROXIMITY OF UTILITIES TO PROPOSED IMPROVEMENTS. CONTRACTOR SHALL NOTIFY U.S.A. TO LOCATE UTILITIES AT THE PROJECT SITE PRIOR TO START OF CONSTRUCTION.
- 3) CONTRACTOR TO REFER TO AS-BUILTS FOR SOUTH BAY SALT PONDS (SBSP) PROJECT AND SAN MATEO COUNTY PUBLIC WORKS PROJECT PRIOR TO CONSTRUCTION.
- 4) ALL PROPERTY LINES SHOWN ARE APPROXIMATED FROM ASSESSORS PARCEL MAPS OR FROM RECORD INFORMATION, AND THEIR LOCATION MAY NOT BE EXACT.
- 5) CONTRACTOR TO INFORM PG&E OF WORK NEAR PG&E'S MAJOR FACILITIES A MINIMUM OF SEVEN WORKING DAYS PRIOR TO WORK IN THE AREA TO ENSURE A PG&E REPRESENTATIVE IS ONSITE TO OBSERVE THE WORK DONE.
- 6) IF SLEEVES ARE FOUND, CONTRACTOR SHALL REMOVE PRIOR TO INSTALLATION OF NEW SS, SSFM, AND RW PIPES.

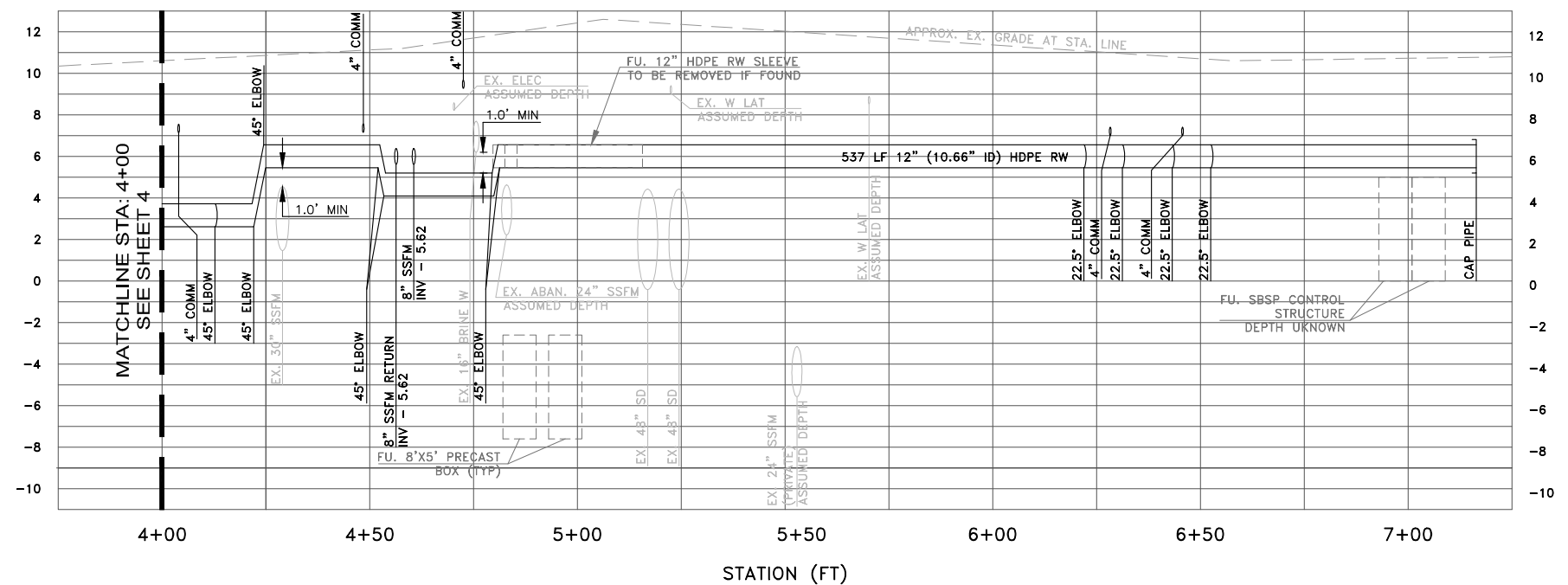

**PROFILE VIEW**  
HORIZ: 1" = 20'  
VERT: 1" = 4'

DATE:	09/07/2022	09/07/2022	BID SET
SCALE:	AS NOTED		
DESIGNED:	LFH & IRP		
DRAWN:	IRP		
CHECKED:	LFH		
PROJ. ENGR:	RJL		
BY	DATE	DESCRIPTION OF REVISIONS	APP'D



150 Executive Park Blvd • San Francisco, CA 94134  
(415)534-7070 • www.freyerlaureta.com

**WEST BAY**  
SANITARY DISTRICT  
SAN MATEO COUNTY  
PROJECT No. 1761.8

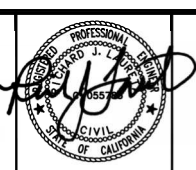

**BAYFRONT PARK SANITARY SEWER  
IMPROVEMENT PROJECT  
MARSH ROAD - RECYCLED WATER  
STA 4+00 - END  
MENLO PARK, CALIFORNIA**

SHEET  
7  
JOB NO.  
1088



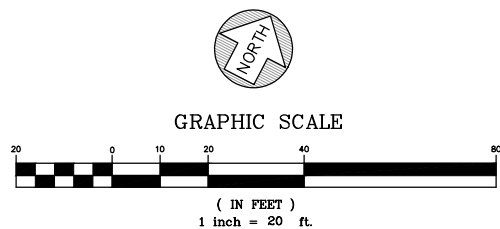
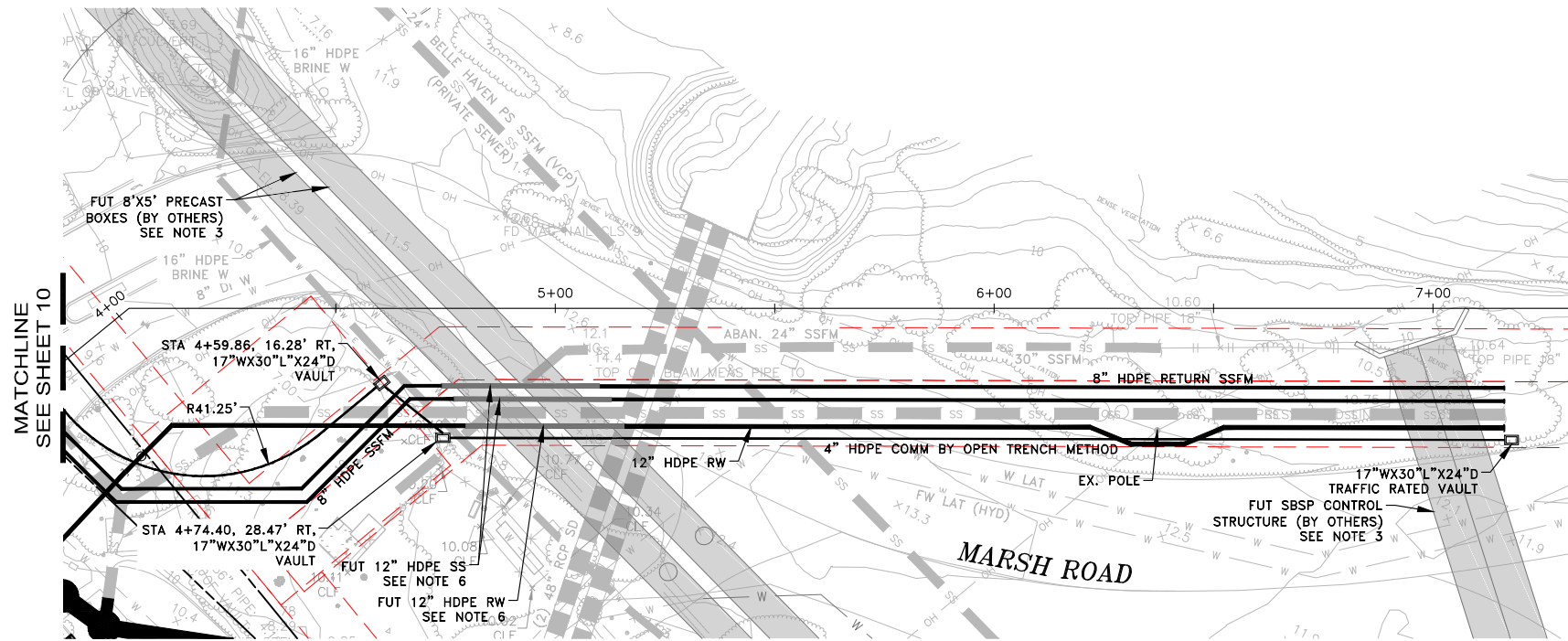

**NOTES:**

- 1) CONTRACTOR SHALL BE RESPONSIBLE FOR THE UNINTERRUPTION OF SEWER SERVICE FOR ALL PROPERTIES. CONTRACTOR SHALL SUBMIT BYPASS PLAN TO THE DISTRICT FOR APPROVAL 10 DAYS PRIOR TO THE PRE-CONSTRUCTION MEETING.
- 2) CONTRACTOR SHALL TAKE ALL NECESSARY PRECAUTIONS TO AVOID ANY DAMAGE TO EXISTING UTILITIES. CONTRACTOR SHALL NOTE THE CLOSE PROXIMITY OF UTILITIES TO PROPOSED IMPROVEMENTS. CONTRACTOR SHALL NOTIFY U.S.A. TO LOCATE UTILITIES AT THE PROJECT SITE PRIOR TO START OF CONSTRUCTION.
- 3) CONTRACTOR TO REFER TO AS-BUILTS FOR SOUTH BAY SALT PONDS (SBSP) PROJECT AND SAN MATEO COUNTY PUBLIC WORKS PROJECT PRIOR TO CONSTRUCTION.
- 4) ALL PROPERTY LINES SHOWN ARE APPROXIMATED FROM ASSESSORS PARCEL MAPS OR FROM RECORD INFORMATION, AND THEIR LOCATION MAY NOT BE EXACT.
- 5) CONTRACTOR TO INFORM PG&E OF WORK NEAR PG&E'S MAJOR FACILITIES A MINIMUM OF SEVEN WORKING DAYS PRIOR TO WORK IN THE AREA TO ENSURE A PG&E REPRESENTATIVE IS ONSITE TO OBSERVE THE WORK DONE.
- 6) IF SLEEVES ARE FOUND, CONTRACTOR SHALL REMOVE PRIOR TO INSTALLATION OF NEW SS, SSFM, AND RW PIPES.

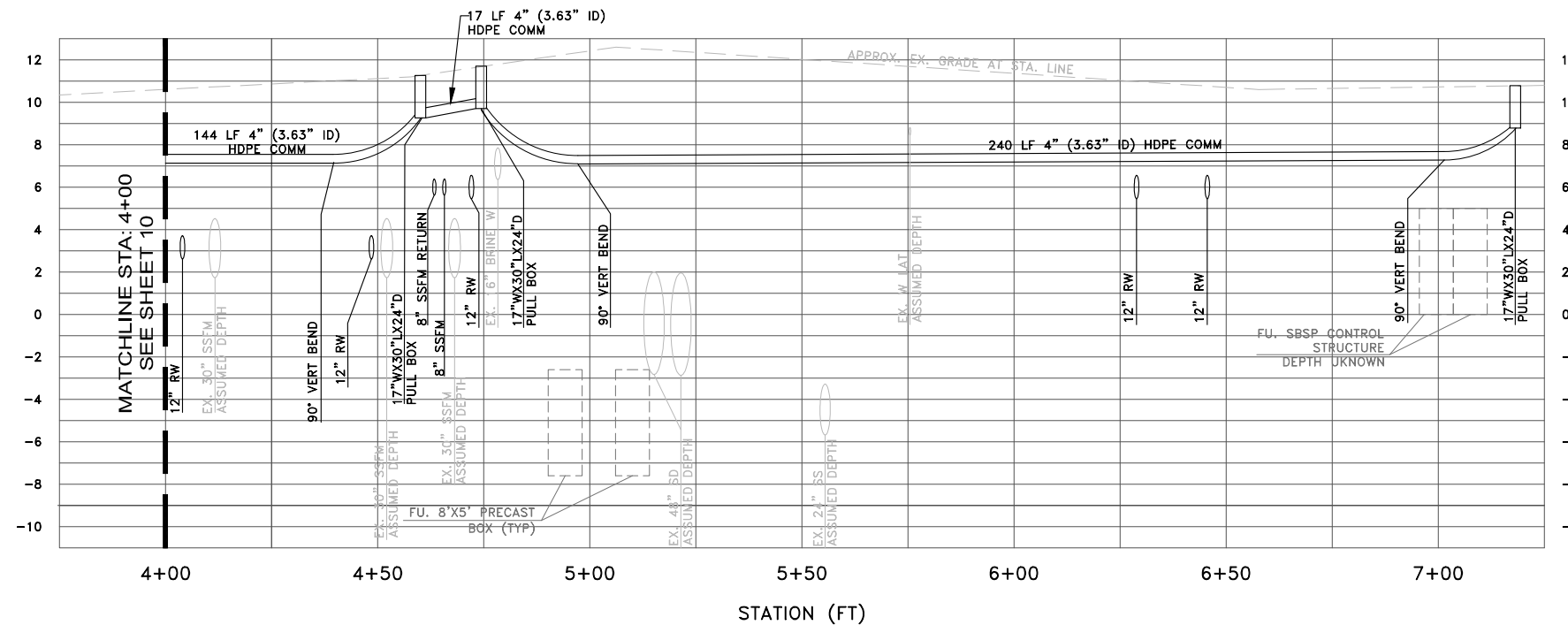

**PROFILE VIEW**  
 HORIZ: 1" = 20'  
 VERT: 1" = 4'

DATE:	09/07/2022	09/07/2022	BID SET
SCALE:	AS NOTED		
DESIGNED:	LFH & IRP		
DRAWN:	IRP		
CHECKED:	LFH		
PROJ. ENGR:	RJL		
BY	DATE	DESCRIPTION OF REVISIONS	APP'D



150 Executive Park Blvd • San Francisco, CA 94134  
 (415)534-7070 • www.freyerlaureta.com

**WEST BAY**  
 SANITARY DISTRICT  
 SAN MATEO COUNTY

PROJECT No. 1761.8



**BAYFRONT PARK SANITARY SEWER  
 IMPROVEMENT PROJECT**  
**MARSH ROAD - TELECOMMUNICATION**  
**MENLO PARK, CALIFORNIA**

SHEET  
**8**  
 JOB NO.  
**1088**

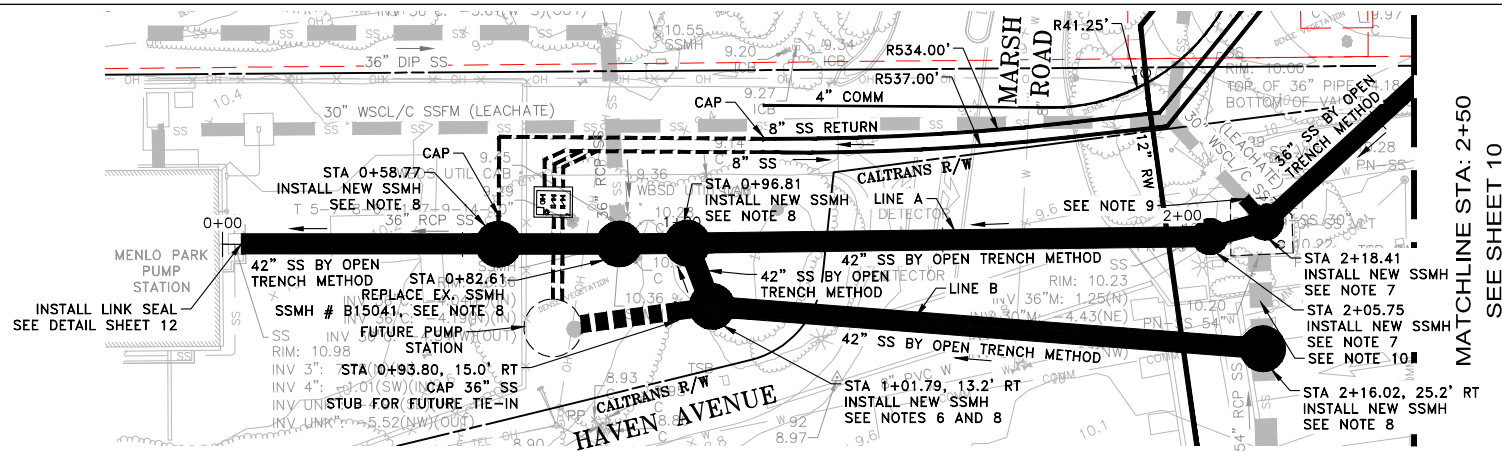

GRAPHIC SCALE

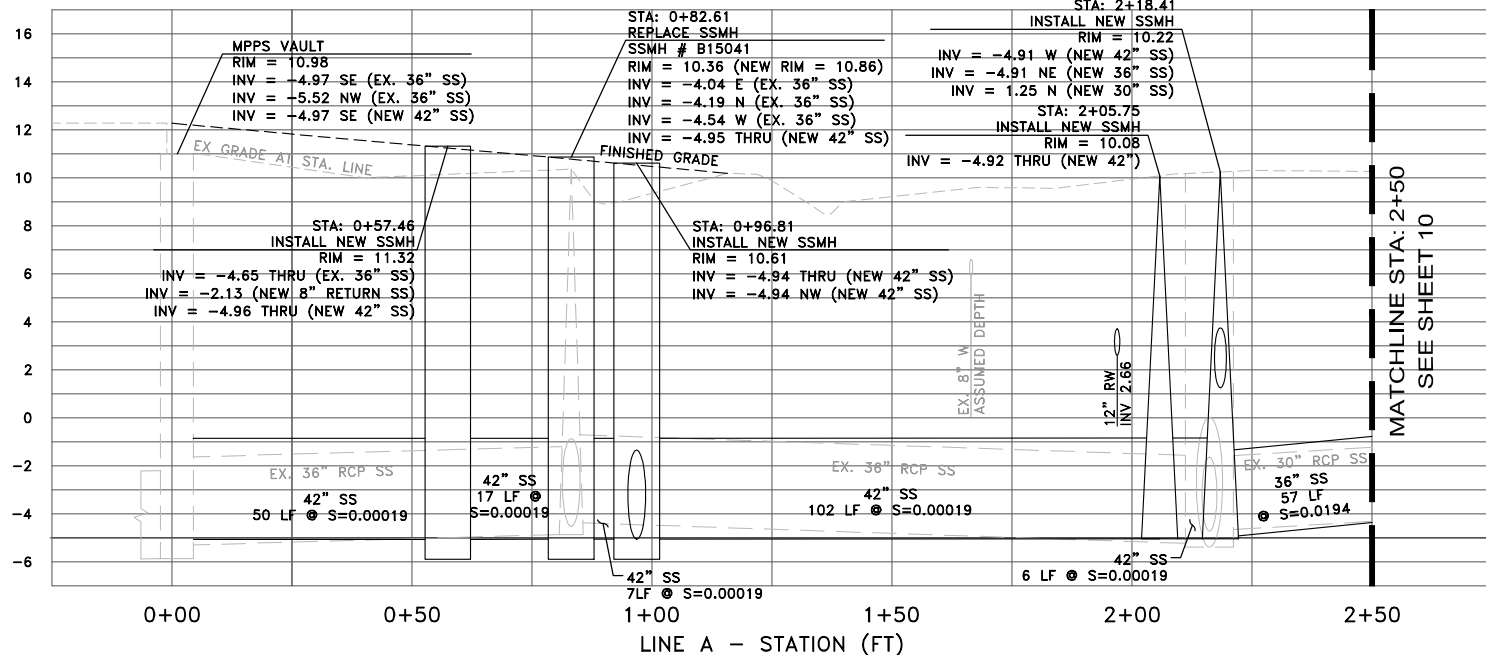
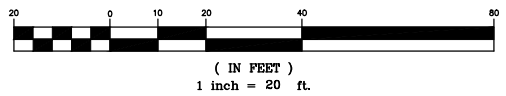

LINE A - STATION (FT)

NOTES:

- 1) CONTRACTOR SHALL BE RESPONSIBLE FOR THE UNINTERRUPTION OF SEWER SERVICE FOR ALL PROPERTIES. CONTRACTOR SHALL SUBMIT BYPASS PLAN TO THE DISTRICT FOR APPROVAL 10 DAYS PRIOR TO THE PRE-CONSTRUCTION MEETING.
- 2) CONTRACTOR SHALL TAKE ALL NECESSARY PRECAUTIONS TO AVOID ANY DAMAGE TO EXISTING UTILITIES. CONTRACTOR SHALL NOTE THE CLOSE PROXIMITY OF UTILITIES TO PROPOSED IMPROVEMENTS. CONTRACTOR SHALL NOTIFY U.S.A. TO LOCATE UTILITIES AT THE PROJECT SITE PRIOR TO START OF CONSTRUCTION.
- 3) CONTACT CALTRANS SEVEN DAYS PRIOR TO WORK WITHIN CALTRANS RIGHT OF WAY.
- 4) ALL PROPERTY LINES SHOWN ARE APPROXIMATED FROM ASSESSORS PARCEL MAPS OR FROM RECORD INFORMATION, AND THEIR LOCATION MAY NOT BE EXACT.
- 5) CONTRACTOR TO INFORM PG&E OF WORK NEAR PG&E'S MAJOR FACILITIES A MINIMUM OF SEVEN WORKING DAYS PRIOR TO WORK IN THE AREA TO ENSURE A PG&E REPRESENTATIVE IS ONSITE TO OBSERVE THE WORK DONE.
- 6) CONTRACTOR TO INSTALL TEMPORARY RESTRICTION IN MANHOLE AT STUBOUT OPENING TO DIRECT FLOWS TO SSMH # B15041.
- 7) INSTALL SSMH PER DETAIL FOR MANHOLE FOR 42" DIAMETER PIPE (REPLACING JUNCTION BOX) ON SHEET 12.
- 8) INSTALL SSMH PER DETAIL FOR OVERSIZED MANHOLE FOR 42" AND EXISTING 54" DIAMETER PIPE ON SHEET 12.
- 9) EXTEND EX. 30" WSCL/C SS BY 4 LF±. SEE LINE A PROFILE FOR INVERT TIE-IN.
- 10) ABANDON EX. 54" RCP IN PLACE. FILL WITH SLURRY AND PLUG BOTH ENDS WITH MINIMUM 12" CONCRETE.

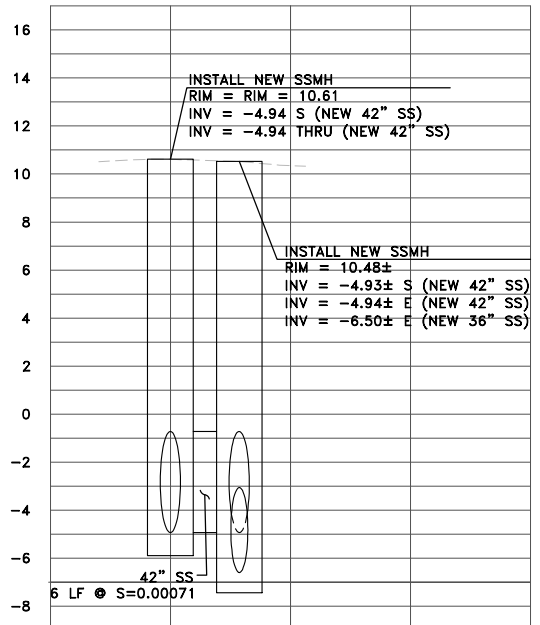

SS CROSSING

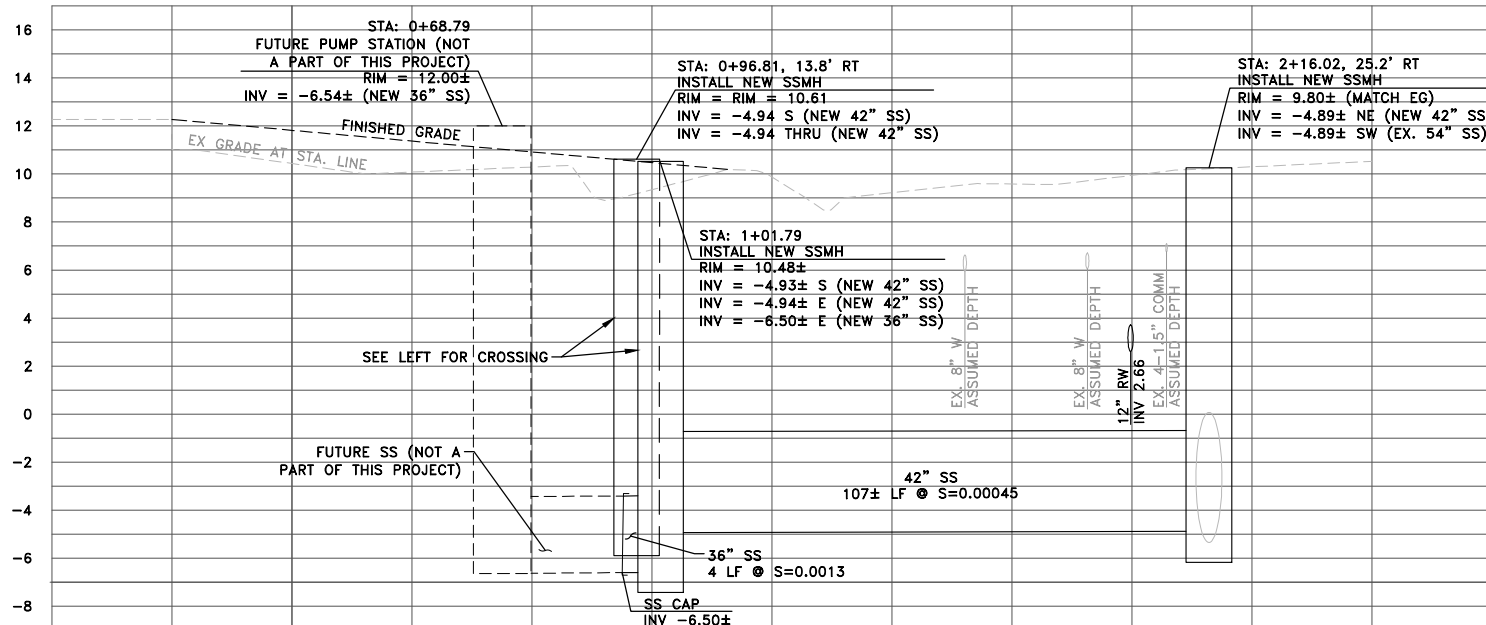

LINE B - STATION (FT)

PROFILE VIEW  
HORIZ: 1" = 20'  
VERT: 1" = 4'

DATE:	09/07/2022	09/07/2022	BID SET
SCALE:	AS NOTED		
DESIGNED:	LFH & IRP		
DRAWN:	IRP		
CHECKED:	LFH		
PROJ. ENGR:	RJL		
BY	DATE	DESCRIPTION OF REVISIONS	APP'D



150 Executive Park Blvd • San Francisco, CA 94134  
(415)534-7070 • www.freyerlaureta.com

**WEST BAY**  
SANITARY DISTRICT  
SAN MATEO COUNTY

PROJECT No. 1761.8



**BAYFRONT PARK SANITARY SEWER  
IMPROVEMENT PROJECT  
FUTURE PUMP STATION - SANITARY SEWER  
STA 0+00 - STA 2+50  
MENLO PARK, CALIFORNIA**

SHEET  
9  
JOB NO.  
1088

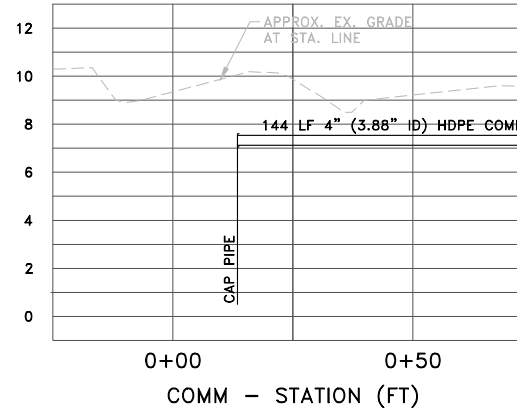
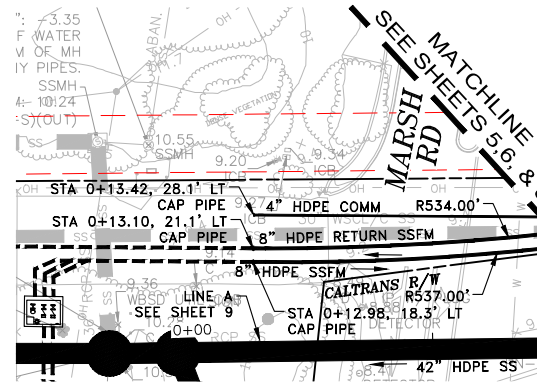
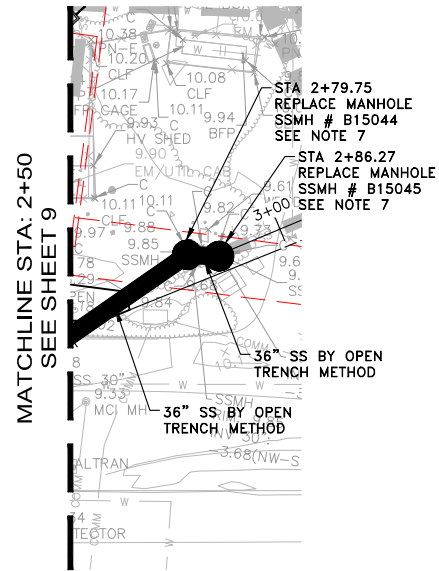

PROFILE VIEW  
HORIZ: 1" = 20'  
VERT: 1" = 4'

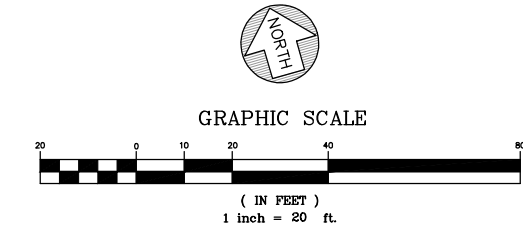

NOTES:

- 1) CONTRACTOR SHALL BE RESPONSIBLE FOR THE UNINTERRUPTION OF SEWER SERVICE FOR ALL PROPERTIES. CONTRACTOR SHALL SUBMIT BYPASS PLAN TO THE DISTRICT FOR APPROVAL 10 DAYS PRIOR TO THE PRE-CONSTRUCTION MEETING.
- 2) CONTRACTOR SHALL TAKE ALL NECESSARY PRECAUTIONS TO AVOID ANY DAMAGE TO EXISTING UTILITIES. CONTRACTOR SHALL NOTE THE CLOSE PROXIMITY OF UTILITIES TO PROPOSED IMPROVEMENTS. CONTRACTOR SHALL NOTIFY U.S.A. TO LOCATE UTILITIES AT THE PROJECT SITE PRIOR TO START OF CONSTRUCTION.
- 3) CONTRACTOR TO REFER TO AS-BUILTS FOR SOUTH BAY SALT PONDS (Sbsp) PROJECT AND SAN MATEO COUNTY PUBLIC WORKS PROJECT PRIOR TO CONSTRUCTION.
- 4) ALL PROPERTY LINES SHOWN ARE APPROXIMATED FROM ASSESSORS PARCEL MAPS OR FROM RECORD INFORMATION, AND THEIR LOCATION MAY NOT BE EXACT.
- 5) CONTRACTOR TO INFORM PG&E OF WORK NEAR PG&E'S MAJOR FACILITIES A MINIMUM OF SEVEN WORKING DAYS PRIOR TO WORK IN THE AREA TO ENSURE A PG&E REPRESENTATIVE IS ONSITE TO OBSERVE THE WORK DONE.
- 6) COMMUNICATION, SSFM, AND RETURN SSFM SHALL BE INSTALLED BY OPEN TRENCH METHOD.
- 7) INSTALL SSMH PER DETAIL FOR MANHOLE FOR 36" DIAMETER PIPE ON SHEET 11.

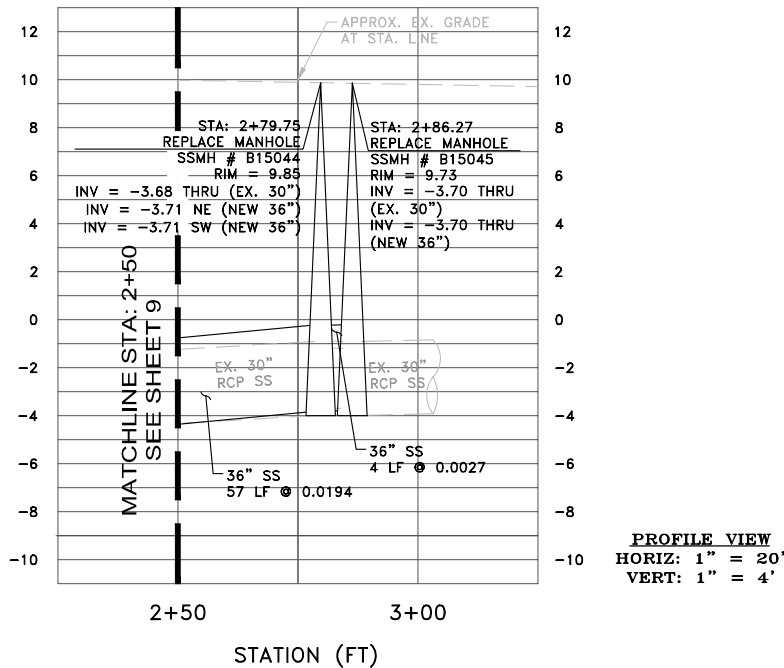

PROFILE VIEW  
HORIZ: 1" = 20'  
VERT: 1" = 4'

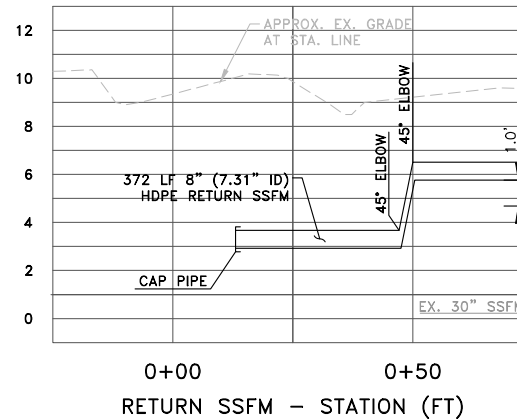

PROFILE VIEW  
HORIZ: 1" = 20'  
VERT: 1" = 4'

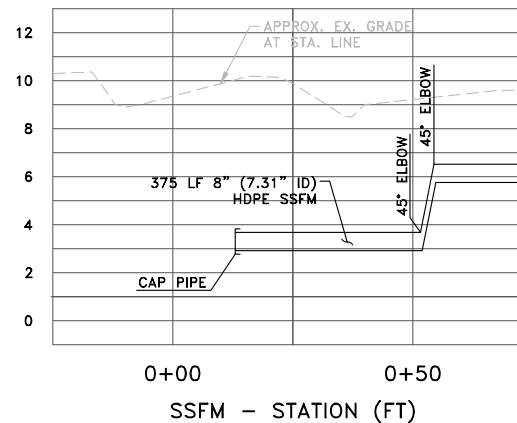

PROFILE VIEW  
HORIZ: 1" = 20'  
VERT: 1" = 4'

DATE: 09/07/2022	09/07/2022	BID SET	
SCALE: AS NOTED			
DESIGNED: LPH & IRP			
DRAWN: IRP			
CHECKED: LFH			
PROJ. ENGR: RJL			
BY	DATE	DESCRIPTION OF REVISIONS	APP'D



150 Executive Park Blvd • San Francisco, CA 94134  
(415)534-7070 • www.freyerlaureta.com

WEST BAY  
SANITARY DISTRICT  
SAN MATEO COUNTY

PROJECT No. 1761.8

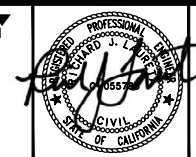

BAYFRONT PARK SANITARY SEWER  
IMPROVEMENT PROJECT  
SANITARY SEWER (STA 2+50 - END),  
TELECOMM, SSFM, RETURN SSFM  
MENLO PARK, CALIFORNIA

SHEET  
10  
JOB NO.  
1088

**NOTES:**

- 1) MANHOLE SHALL BE VACUUM TESTED.
- 2) ECCENTRIC CONE SHALL BE POSITIONED IN SUCH A MANNER OVER CENTER OF PIPE FOR INSTALLATION OF FLOW METER SENSOR BRACKET.
- 3) TRACE WIRE SHALL BE SOLID AND COATED 8 GAUGE COPPER WIRE PLACED 12" BELOW RIM WITH 3" COILED UP IN MANHOLE.
- 4) SHEAR JOINT SHALL BE INSTALLED ON ALL INCOMING AND OUTGOING PIPES A DISTANCE OF ONE PIPE DIAMETER AWAY FROM THE OUTSIDE OF THE MANHOLE.

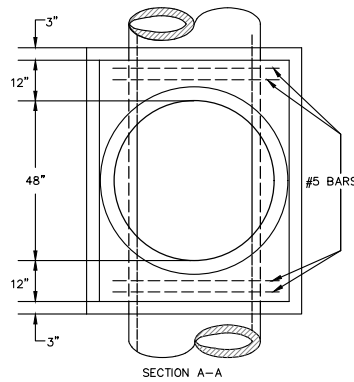

D&L FOUNDRY  
STD. A-1024  
MANHOLE RING  
AND COVER OR  
APPROVED EQUAL.

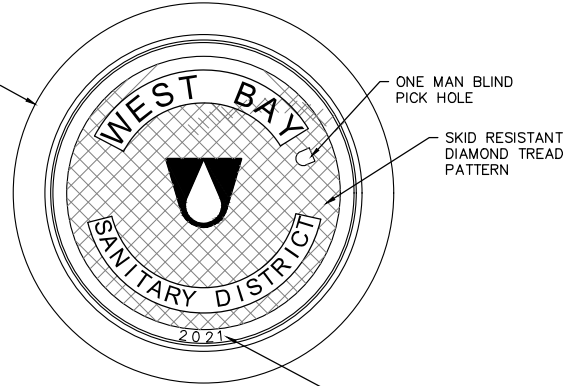

THE YEAR SHOWN SHALL BE THE YEAR THE FRAME AND COVER ARE INSTALLED

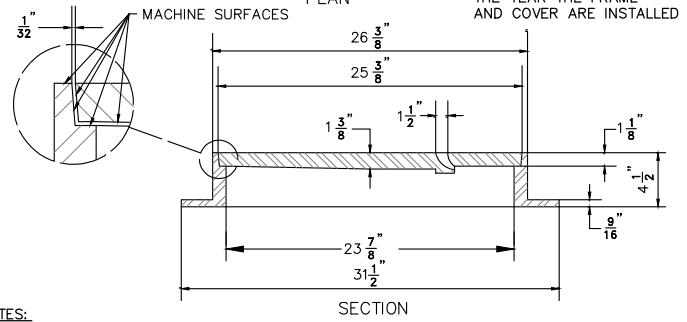

**NOTES:**

1. CAST IRON FOR FRAME AND COVER SHALL BE CLASS 30 MINIMUM PER ASTM A-48.
2. COVERS SHALL BE H-20, FULL VEHICULAR TRAFFIC LOADING, RATED AND SHALL NOT EXCEED 145 POUNDS IN WEIGHT.
3. THE FRAME AND COVER SHALL BE PAINTED OR DIPPED IN ASPHALT PRIOR TO LEAVING FOUNDRY.

**MANHOLE FRAME AND COVER**

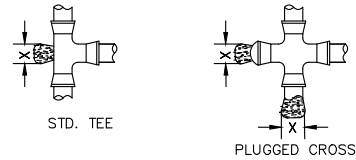
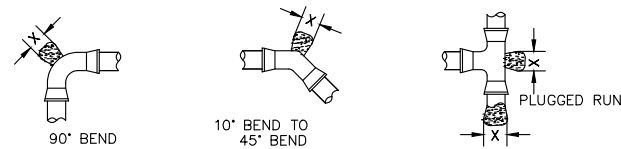

**NOTES:**

1. ALL THRUST BLOCK SHALL BEAR AGAINST UNDISTURBED EARTH.
2. CONCRETE SHALL BE CLASS A.

AREA (X) IN SQ. FEET

TYPE OF FITTING	SIZE OF PIPE			
	4"	6"	8"	12"
90° ELL	2	5	8	18
45° ELL	1	3	5	10
12 1/2' ELL	1	2	3	3
11 1/4' ELL	1	1	2	3
PLUG/TEE	1.5	4	6	13

BASED ON SOIL BEARING VALUE OF 2000 LBS PER SQ. FT. AND WATER PRESSURE OF 224 PSI. F-FORM AS REQUIRED TO KEEP CONCRETE OFF MECHANICAL JOINT OR FLANGE BOLTS.

**THRUST BLOCK DETAIL**

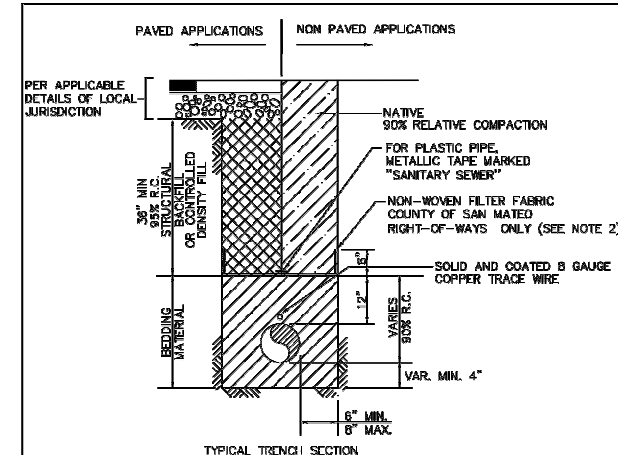

**BEDDING MATERIAL**

SIEVE SIZES	PERCENTAGE PASSING
1"	100
3/4"	90-100
20-55	20-55
#4	0-10
#8	0-5

**STRUCTURAL BACKFILL**

SIEVE SIZES	PERCENTAGE PASSING
1-1/2"	100
3/4"	80-100
#4	30-50
#30	5-30
#200	0-12

**NOTES:**

- 1) STRUCTURE BACKFILL AND BEDDING SHALL ALL BE VIRGIN MATERIALS.
- 2) IN COUNTY OF SAN MATEO RIGHT-OF-WAYS ONLY, NON-WOVEN FILTER FABRIC SHALL BE PLACED AS SHOWN PRIOR TO BACKFILLING ABOVE PIPE ZONE. FILTER FABRIC SHALL BE LAPPED 6" LONGITUDINALLY.

**WEST BAY SANITARY DISTRICT**

EXCAVATION, BACKFILL, AND SURFACE RESTORATION

APPROVED BY: AS / SERGIO RAMIREZ 08-04-20 8

DISTRICT MANAGER DATE

**WEST BAY SANITARY DISTRICT DETAIL 8**

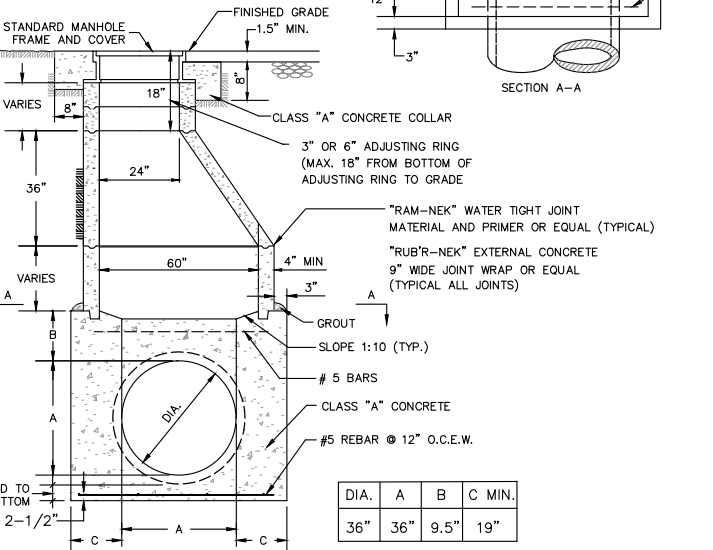

**MANHOLE FOR 36" DIAMETER PIPE**

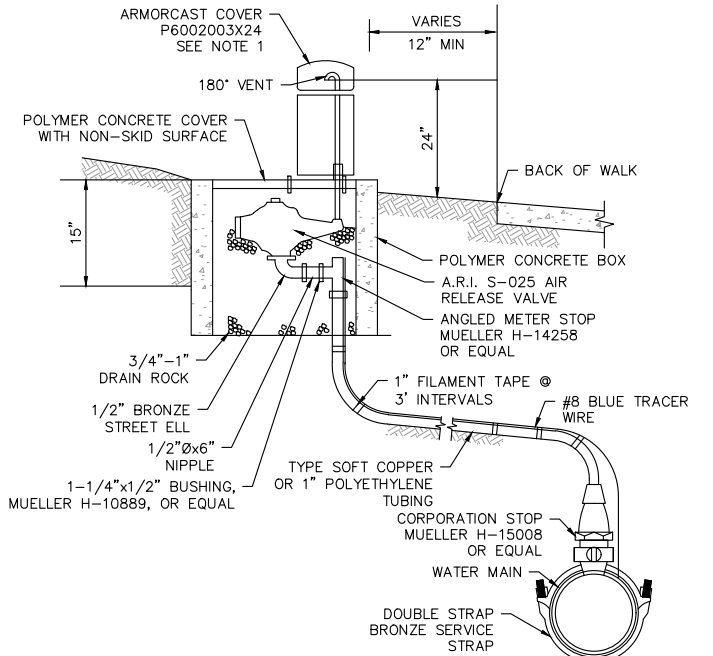

**NOTES:**

1. ARMORCAST COVER SHALL HAVE A SINGLE PURPLE COLOR STRIPE NEAR THE TOP FOR RECYCLED WATER.
2. STAINLESS STEEL BOLTS, 304 OR 316, REQUIRED ABOVE AND BELOW GROUND.

**AIR RELEASE VALVE RECYCLED WATER**

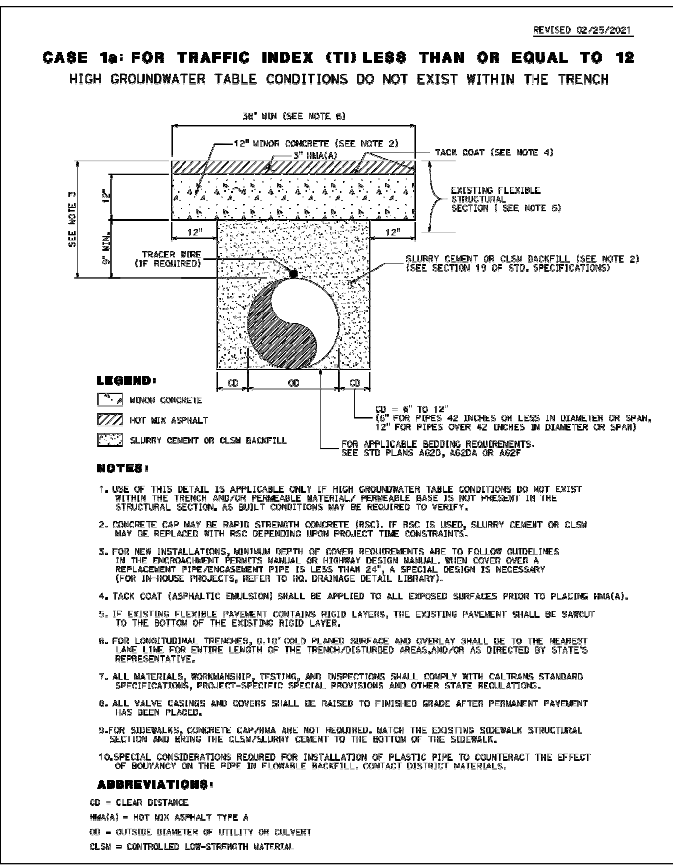

**UTILITY TRENCH DETAIL - CALTRANS ROW**

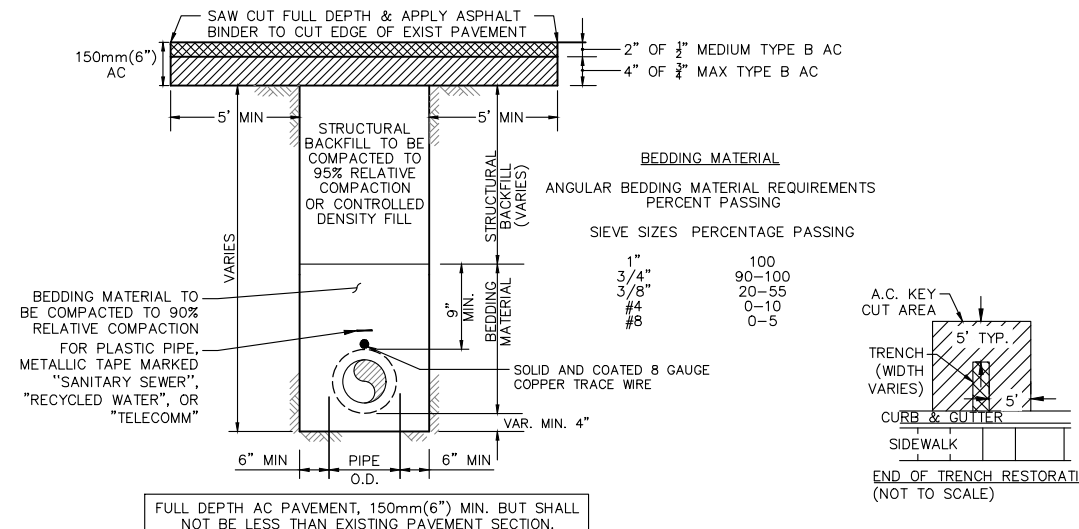

**NOTES:**

1. THE MIX DESIGN FOR CDF SHALL MEET THE FOLLOWING REQUIREMENTS:  
CEMENT 50-100 LB/CU. YD  
FLY ASH, CLASS F 10-2000 LB/CU. YD  
FINE AGGREGATE 2600-3100 LB/CU. YD  
WATER 325/580 LB/CU. YD  
STRENGTH @ 28 DAY 50-100 PSI
2. STRUCTURAL BACKFILL MATERIAL: MATERIAL WITH SAND EQUIVALENT NOT LESS THAN 20 AND SIEVE GRADATION BY MATERIAL AS FOLLOWS:  
SIEVE SIZE % PASSING SIEVE  
75mm (3") 100  
No. 4 35-100  
No. 30 20-100
3. SLURRY SEALING: SEE "STANDARDS FOR TRENCH CONSTRUCTION SEAL COAT" DETAIL
4. THE WEST BAY SANITARY DISTRICT SHALL BE RESPONSIBLE FOR THE PAYMENT OF PAVEMENT RESTORATION OVER THE MAXIMUM TRENCH WIDTH AS SHOWN ON THE ABOVE DETAIL. ANYTHING BEYOND THE MAXIMUM TRENCH WIDTH, INCLUDING PAVEMENT FAILURE CAUSED BY THE CONTRACTOR, SHALL BE THE RESPONSIBILITY OF THE CONTRACTOR, UNLESS AUTHORIZED BY THE DISTRICT.
5. CONTRACTOR SHALL PLACE SLURRY SEAL IN CONFORMANCE WITH CITY OF MENLO PARK STANDARD DETAIL ST-16, PER CITY OF MENLO PARK STANDARD DETAIL ST-9A.

**UTILITY TRENCH-CITY OF MENLO PARK-RIGHT OF WAY (MODIFIED PER CITY OF MENLO PARK STANDARDS)**

DATE: 09/07/2022	09/07/2022	BID SET
SCALE: AS NOTED		
DESIGNED: LFH & IRP		
DRAWN: IRP		
CHECKED: LFH		
PROJ. ENGR: RJL		
BY	DATE	DESCRIPTION OF REVISIONS
		APP'D

**FREYER & LAURETA, INC.**

CIVIL ENGINEERS • SURVEYORS • CONSTRUCTION MANAGERS

150 Executive Park Blvd • San Francisco, CA 94134  
(415)534-7070 • www.freyerlaureta.com

**WEST BAY SANITARY DISTRICT**

SAN MATEO COUNTY

PROJECT No. 1761.8



**BAYFRONT PARK SANITARY SEWER IMPROVEMENT PROJECT**

DETAIL SHEET #1

**MENLO PARK, CALIFORNIA**

SHEET	11
JOB NO.	1088

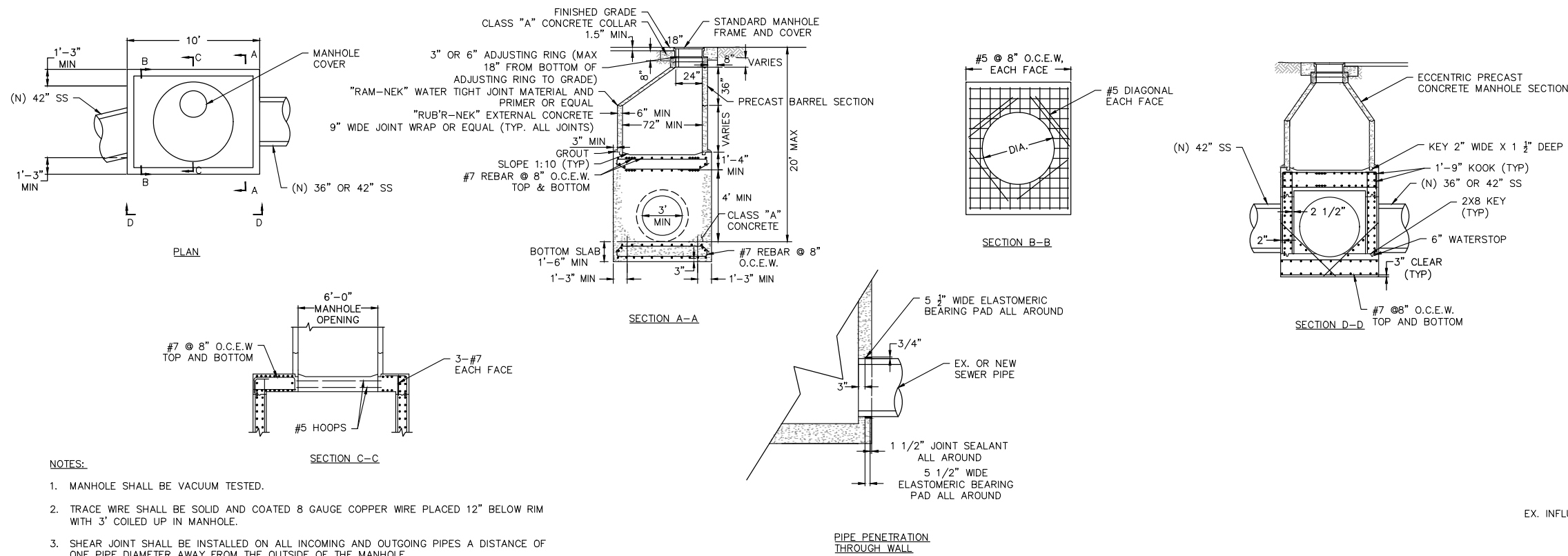

**NOTES:**

1. MANHOLE SHALL BE VACUUM TESTED.
2. TRACE WIRE SHALL BE SOLID AND COATED 8 GAUGE COPPER WIRE PLACED 12" BELOW RIM WITH 3' COILED UP IN MANHOLE.
3. SHEAR JOINT SHALL BE INSTALLED ON ALL INCOMING AND OUTGOING PIPES A DISTANCE OF ONE PIPE DIAMETER AWAY FROM THE OUTSIDE OF THE MANHOLE.

**MANHOLE FOR 42" DIAMETER PIPE (REPLACING JUNCTION BOX)**

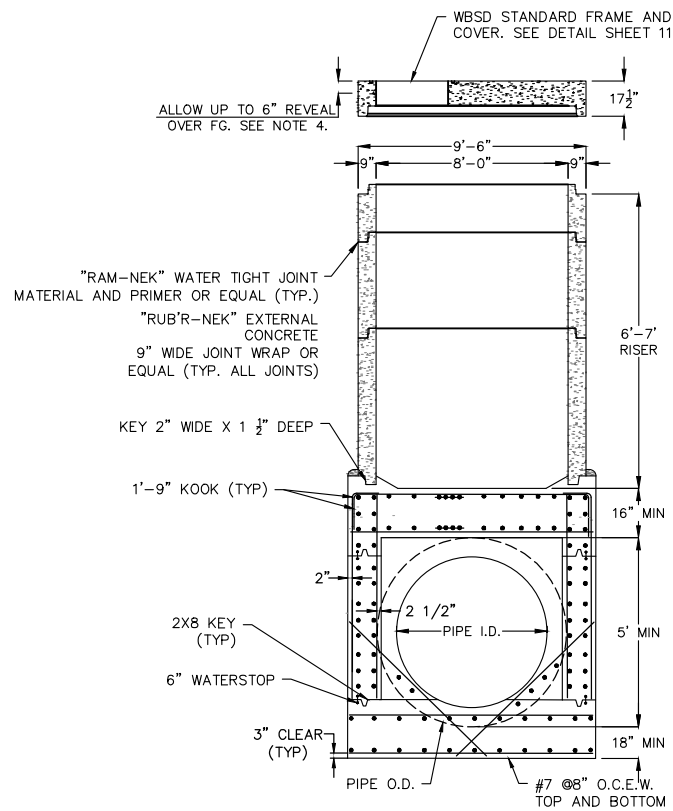

**OVERSIZED MANHOLE FOR 42" AND EXISTING 54" DIAMETER PIPE**

**NOTES:**

1. MANHOLE RISERS AND TOP SHALL BE JENSEN PRECAST 96" I.D. MANHOLE OR EQUIVALENT.
2. MANHOLE BASE SHALL BE CAST-IN-PLACE.
3. DESIGN LOAD: MANHOLE COMPONENTS CONFORM TO ASTM C-478 AND AASHTO M-199. FLAT TOPS AND BASE SLABS ARE DESIGNED FOR H-20 TRAFFIC TO 30' STACK HEIGHT.
4. MANHOLE COVER SHALL BE PLACED AT AN ECCENTRIC LOCATION.
5. FOR MANHOLE WITHIN CALTRANS ROW ON BAYFRONT EXPRESSWAY, MANHOLE TOP SHALL BE FLUSH WITH EXISTING GROUND.

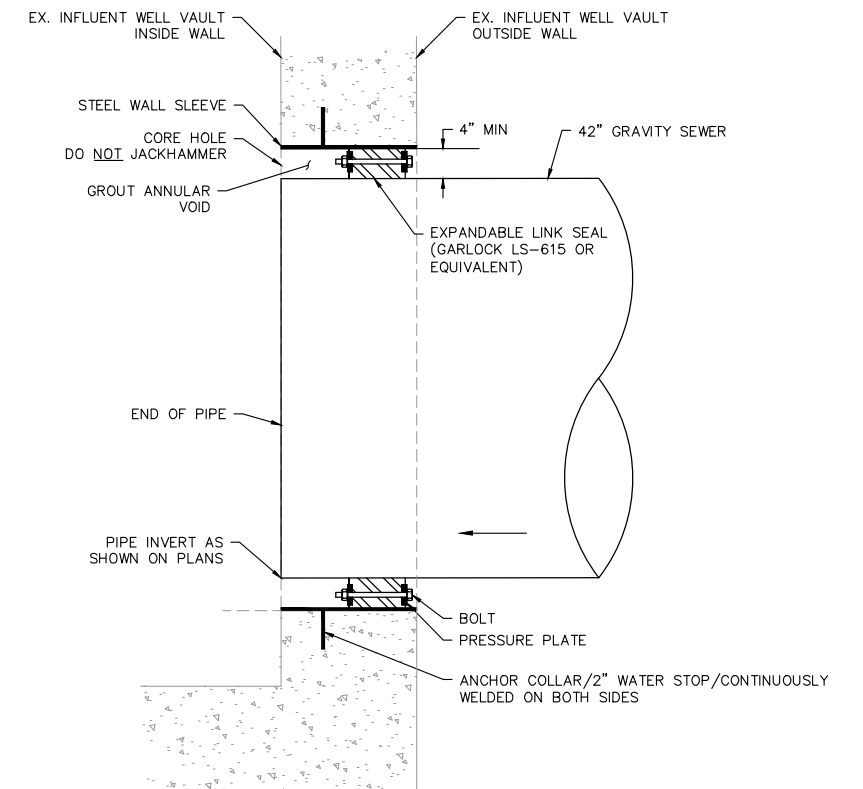

**NOTES:**

1. REFER TO GARLOCK "LINK SEAL MODULAR SEALS WITH MODEL WS STEEL WALL SLEEVES" SPECS FOR MORE INFORMATION.

**SANITARY SEWER PUMP STATION GRAVITY MAIN WALL PENETRATION DETAIL**

DATE:	09/07/2022	09/07/2022	BID SET
SCALE:	AS NOTED		
DESIGNED:	LFH & IRP		
DRAWN:	IRP		
CHECKED:	LFH		
PROJ. ENGR:	RJL		
BY	DATE	DESCRIPTION OF REVISIONS	APP'D



150 Executive Park Blvd • San Francisco, CA 94134  
(415)534-7070 • www.freyerlaureta.com

**WEST BAY**  
SANITARY DISTRICT  
SAN MATEO COUNTY

PROJECT No. 1761.8



**BAYFRONT PARK SANITARY SEWER  
IMPROVEMENT PROJECT  
DETAIL SHEET #2  
MENLO PARK, CALIFORNIA**

SHEET

12

JOB NO.

1088



SAN MATEO COUNTYWIDE  
**Water Pollution  
 Prevention Program**  
 Clean Water. Healthy Community.

# Construction Best Management Practices (BMPs)

Construction projects are required to implement the stormwater best management practices (BMP) on this page, as they apply to your project, all year long.

## Materials & Waste Management

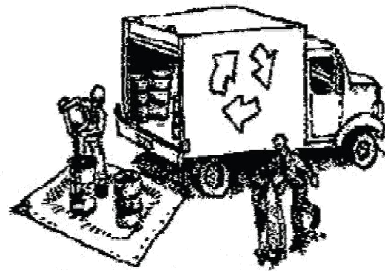

### Non-Hazardous Materials

- ❑ Berm and cover stockpiles of sand, dirt or other construction material with tarps when rain is forecast or if not actively being used within 14 days.
- ❑ Use (but don't overuse) reclaimed water for dust control.

### Hazardous Materials

- ❑ Label all hazardous materials and hazardous wastes (such as pesticides, paints, thinners, solvents, fuel, oil, and antifreeze) in accordance with city, county, state and federal regulations.
- ❑ Store hazardous materials and wastes in water tight containers, store in appropriate secondary containment, and cover them at the end of every work day or during wet weather or when rain is forecast.
- ❑ Follow manufacturer's application instructions for hazardous materials and be careful not to use more than necessary. Do not apply chemicals outdoors when rain is forecast within 24 hours.
- ❑ Arrange for appropriate disposal of all hazardous wastes.

### Waste Management

- ❑ Cover waste disposal containers securely with tarps at the end of every work day and during wet weather.
- ❑ Check waste disposal containers frequently for leaks and to make sure they are not overfilled. Never hose down a dumpster on the construction site.
- ❑ Clean or replace portable toilets, and inspect them frequently for leaks and spills.
- ❑ Dispose of all wastes and debris properly. Recycle materials and wastes that can be recycled (such as asphalt, concrete, aggregate base materials, wood, gyp board, pipe, etc.)
- ❑ Dispose of liquid residues from paints, thinners, solvents, glues, and cleaning fluids as hazardous waste.

### Construction Entrances and Perimeter

- ❑ Establish and maintain effective perimeter controls and stabilize all construction entrances and exits to sufficiently control erosion and sediment discharges from site and tracking off site.
- ❑ Sweep or vacuum any street tracking immediately and secure sediment source to prevent further tracking. Never hose down streets to clean up tracking.

## Equipment Management & Spill Control



### Maintenance and Parking

- ❑ Designate an area, fitted with appropriate BMPs, for vehicle and equipment parking and storage.
- ❑ Perform major maintenance, repair jobs, and vehicle and equipment washing off site.
- ❑ If refueling or vehicle maintenance must be done onsite, work in a bermed area away from storm drains and over a drip pan or drop cloths big enough to collect fluids. Recycle or dispose of fluids as hazardous waste.
- ❑ If vehicle or equipment cleaning must be done onsite, clean with water only in a bermed area that will not allow rinse water to run into gutters, streets, storm drains, or surface waters.
- ❑ Do not clean vehicle or equipment onsite using soaps, solvents, degreasers, or steam cleaning equipment.

### Spill Prevention and Control

- ❑ Keep spill cleanup materials (e.g., rags, absorbents and cat litter) available at the construction site at all times.
- ❑ Inspect vehicles and equipment frequently for and repair leaks promptly. Use drip pans to catch leaks until repairs are made.
- ❑ Clean up spills or leaks immediately and dispose of cleanup materials properly.
- ❑ Do not hose down surfaces where fluids have spilled. Use dry cleanup methods (absorbent materials, cat litter, and/or rags).
- ❑ Sweep up spilled dry materials immediately. Do not try to wash them away with water, or bury them.
- ❑ Clean up spills on dirt areas by digging up and properly disposing of contaminated soil.
- ❑ Report significant spills immediately. You are required by law to report all significant releases of hazardous materials, including oil. To report a spill: 1) Dial 911 or your local emergency response number, 2) Call the Governor's Office of Emergency Services Warning Center, (800) 852-7550 (24 hours).

## Earthmoving

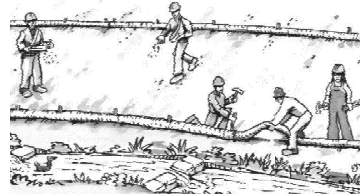

- ❑ Schedule grading and excavation work during dry weather.
- ❑ Stabilize all denuded areas, install and maintain temporary erosion controls (such as erosion control fabric or bonded fiber matrix) until vegetation is established.
- ❑ Remove existing vegetation only when absolutely necessary, and seed or plant vegetation for erosion control on slopes or where construction is not immediately planned.
- ❑ Prevent sediment from migrating offsite and protect storm drain inlets, gutters, ditches, and drainage courses by installing and maintaining appropriate BMPs, such as fiber rolls, silt fences, sediment basins, gravel bags, berms, etc.
- ❑ Keep excavated soil on site and transfer it to dump trucks on site, not in the streets.

### Contaminated Soils

- ❑ If any of the following conditions are observed, test for contamination and contact the Regional Water Quality Control Board:
  - Unusual soil conditions, discoloration, or odor.
  - Abandoned underground tanks.
  - Abandoned wells
  - Buried barrels, debris, or trash.

## Paving/Asphalt Work



- ❑ Avoid paving and seal coating in wet weather or when rain is forecast, to prevent materials that have not cured from contacting stormwater runoff.
- ❑ Cover storm drain inlets and manholes when applying seal coat, tack coat, slurry seal, fog seal, etc.
- ❑ Collect and recycle or appropriately dispose of excess abrasive gravel or sand. Do NOT sweep or wash it into gutters.
- ❑ Do not use water to wash down fresh asphalt concrete pavement.

### Sawcutting & Asphalt/Concrete Removal

- ❑ Protect nearby storm drain inlets when saw cutting. Use filter fabric, catch basin inlet filters, or gravel bags to keep slurry out of the storm drain system.
- ❑ Shovel, absorb, or vacuum saw-cut slurry and dispose of all waste as soon as you are finished in one location or at the end of each work day (whichever is sooner!).
- ❑ If sawcut slurry enters a catch basin, clean it up immediately.

## Concrete, Grout & Mortar Application

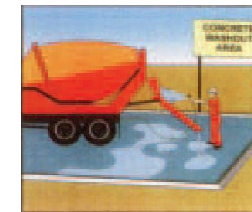

- ❑ Store concrete, grout, and mortar away from storm drains or waterways, and on pallets under cover to protect them from rain, runoff, and wind.
- ❑ Wash out concrete equipment/trucks offsite or in a designated washout area, where the water will flow into a temporary waste pit, and in a manner that will prevent leaching into the underlying soil or onto surrounding areas. Let concrete harden and dispose of as garbage.
- ❑ When washing exposed aggregate, prevent washwater from entering storm drains. Block any inlets and vacuum gutters, hose washwater onto dirt areas, or drain onto a bermed surface to be pumped and disposed of properly.

## Landscaping



- ❑ Protect stockpiled landscaping materials from wind and rain by storing them under tarps all year-round.
- ❑ Stack bagged material on pallets and under cover.
- ❑ Discontinue application of any erodible landscape material within 2 days before a forecast rain event or during wet weather.

## Painting & Paint Removal

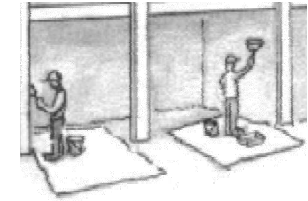

### Painting Cleanup and Removal

- ❑ Never clean brushes or rinse paint containers into a street, gutter, storm drain, or stream.
- ❑ For water-based paints, paint out brushes to the extent possible, and rinse into a drain that goes to the sanitary sewer. Never pour paint down a storm drain.
- ❑ For oil-based paints, paint out brushes to the extent possible and clean with thinner or solvent in a proper container. Filter and reuse thinners and solvents. Dispose of excess liquids as hazardous waste.
- ❑ Paint chips and dust from non-hazardous dry stripping and sand blasting may be swept up or collected in plastic drop cloths and disposed of as trash.
- ❑ Chemical paint stripping residue and chips and dust from marine paints or paints containing lead, mercury, or tributyltin must be disposed of as hazardous waste. Lead based paint removal requires a state-certified contractor.

## Dewatering

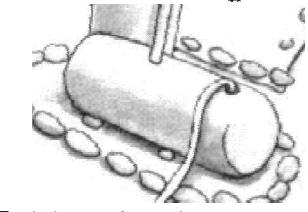

- ❑ Discharges of groundwater or captured runoff from dewatering operations must be properly managed and disposed. When possible send dewatering discharge to landscaped area or sanitary sewer. If discharging to the sanitary sewer call your local wastewater treatment plant.
- ❑ Divert run-on water from offsite away from all disturbed areas.
- ❑ When dewatering, notify and obtain approval from the local municipality before discharging water to a street gutter or storm drain. Filtration or diversion through a basin, tank, or sediment trap may be required.
- ❑ In areas of known or suspected contamination, call your local agency to determine whether the ground water must be tested. Pumped groundwater may need to be collected and hauled off-site for treatment and proper disposal.

**Storm drain polluters may be liable for fines of up to \$10,000 per day!**

DATE:	09/07/2022	09/07/2022	BID SET
SCALE:	AS NOTED		
DESIGNED:	LFH & IRP		
DRAWN:	IRP		
CHECKED:	LFH		
PROJ. ENGR:	RJL		
BY	DATE	DESCRIPTION OF REVISIONS	APP'D

**FL FREYER & LAURETA, INC.**  
 CIVIL ENGINEERS • SURVEYORS • CONSTRUCTION MANAGERS

150 Executive Park Blvd. • San Francisco, CA 94134  
 (415)534-7070 • www.freyerlaureta.com

**WEST BAY  
 SANITARY DISTRICT  
 SAN MATEO COUNTY**

PROJECT No. 1761.8

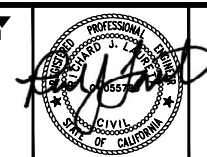

**BAYFRONT PARK SANITARY SEWER  
 IMPROVEMENT PROJECT  
 SAN MATEO COUNTY BMP  
 MENLO PARK, CALIFORNIA**

SHEET  
 13  
 JOB NO.  
 1088